

Contents

Important User Information	2	Standard Floor Track Installation	12
General	2	Before Starting the Assembly	12
Manufacturer	2	Layout the Space	12
Intended Use	2	Attach Floor Track to Floor	14
Warranty	2	Track Stop Bracket Accessory Installation	16
Safety Precautions	3	Adjustable Track Lock Accessory Operation	17
General	3	Cart Assembly	19
Installation	3	Attach Wheels to an X-Cart	19
General Usage	3	Attach Casters to a Team Cart	20
Parts Lists	4	Place Frame Bumpers	21
Carts	4	Assemble Front End Frame	22
Wire-grille End Panel	4	Assemble Rear End Frame	26
Cart Hardware Pack Components	5	Top Panel Assembly	29
Cart Hardware Pack Supplied Hardware	5	Moving Carts	30
Cart Knuckle Pack Components	6	General	30
Cart Knuckle Hardware Pack Supplied Hardware	6	Moving Carts On and Off of a Floor Track	31
Floor Track and Hardware	7	Replacement Parts	32
Track Stop Bracket	7	X-Cart Chassis	32
Adjustable Track Lock	7	Team Cart Chassis	33
Description	8	End Frame	34
X Cart	8	Wire-grille End Panel	35
Team Cart	9	Top Panel Assembly	35
Floor Track	10	Floor Track	36
Track Stop and Adjustable Track Lock	10	Track Stop Bracket	36
Required Tools	11	Adjustable Track Lock	36
Load Capacity	11		
Maintenance	11		



Visit the GearBoss High-Density Storage System web page at gearboss.com for more information.

Note: Please read and understand these instructions before proceeding.
Note: If you need additional information, contact Wenger Corporation using the information below.

Important User Information

General

Copyright © 2024 by Wenger Corporation

All rights reserved. No part of the contents of this manual may be reproduced, copied, or transmitted in any form or by any means including graphic, electronic, or mechanical methods or photocopying, recording, or information storage and retrieval systems without the written permission of the publisher, unless it is for the purchaser's personal use.

Printed and bound in the United States of America.

The information in this manual is subject to change without notice and does not represent a commitment on the part of Wenger Corporation. Wenger Corporation does not assume any responsibility for any errors that may appear in these instructions.

In no event will Wenger Corporation be liable for technical or editorial omissions made herein, nor for direct, indirect, special, incidental, or consequential damages resulting from the use or defect of these instructions. The manufacturer reserves the right to change this product at any time.

The information in this document is not intended to cover all possible conditions and situations that might occur. The end user must exercise caution and common sense when assembling or installing Wenger Corporation products. If any questions or problems arise, call the Wenger Corporation at (800) 4WENGER (493-6437) or +1-507-455-4100 worldwide.

Manufacturer

The GearBoss® X-Cart™ and Team Cart™ are manufactured by:

Wenger Corporation
555 Park Drive
Owatonna, MN 55060
(800) 4WENGER (493-6437) • +1 (507) 455-4100
wengercorp.com

Intended Use

- This product is intended for indoor use in normal ambient temperature and humidity conditions – it must not be exposed to outside weather conditions.
- This product is intended to be assembled, installed and used only as described in these instructions.

Warranty

Warranty information is available at wengercorp.com.

Safety Precautions

Throughout this document you may find cautions and warnings which are defined as follows:

- **WARNING:** Failure to follow the instruction could result in serious injury or damage to property.
- **CAUTION:** Failure to follow the instruction could result in minor injury or damage to property.

Read all of these safety instructions before assembly, installation or use.

General

⚠ CAUTION

Make sure anyone assembling, installing or using this product has read and understands these instructions.

⚠ CAUTION

Failure to comply with Warnings and Cautions in this document or on the equipment can result in damage to property or injury.

Installation

⚠ WARNING

*Installing on floor surfaces that are not level or that have rough and uneven areas can result in a system not performing correctly.
Failure to observe this Warning can result in carts not remaining in place, not being stable and not being safe when moving on the floor track.*

⚠ CAUTION

Never stand on a cart, use a ladder or step stool if necessary.

⚠ CAUTION

Some assembly steps require that two or more persons work together. Some components are heavy and are difficult to handle alone.

General Usage

⚠ WARNING

Do not place more than 150 lb (68 kg) onto the cart top panel. Failure to observe this Warning can result in a structural failure and inability to open and close bypass doors.

⚠ WARNING

Never place a cart sideways on an inclined ramp where they can tip over.

⚠ WARNING

Always move carts on the track at a slow walk or about 1' (305 mm) per second. Moving the cart rapidly on the track and striking an obstruction with heavy loading on the upper part of the cart can result in tipping over.

⚠ CAUTION

Two people must always work together when moving cart that is not on the track (one person pushing at the rear and one person guiding the cart at the front).

⚠ CAUTION

Never place hands or feet onto the track or cart pathway when moving carts.

⚠ CAUTION

Never allow people to stand or ride on the cart.

Parts Lists

Carts

NOTICE

Applies to both X-Carts (shown) and Team Carts in 32" (813 mm) and 48" (1219 mm) widths.

Item	Qty	Description
12	1	Front End Frame Assembly
13	1	Rear End Frame Assembly
14	1	Chassis
15	2	Top Panel Extrusion Assembly
16	1	Top Panel

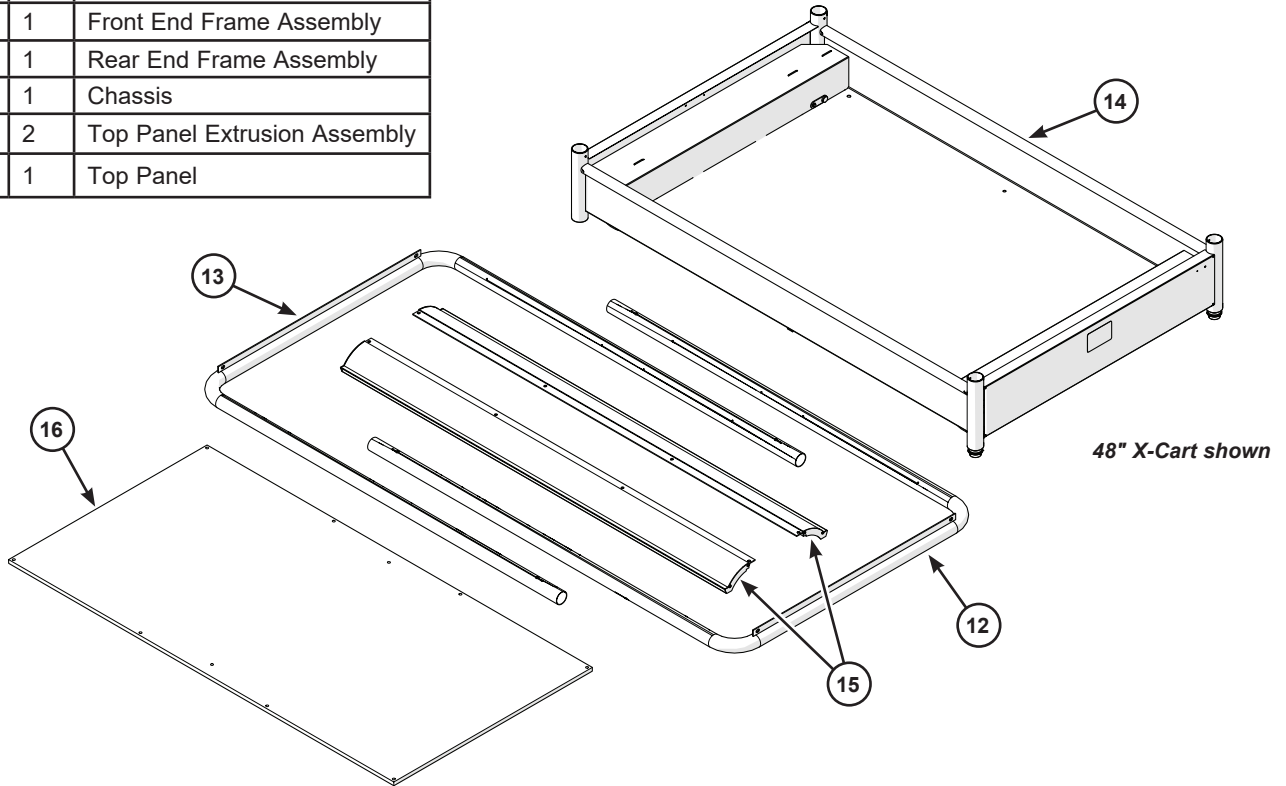

Wire-grille End Panel

NOTICE

Applies to both X-Carts (shown) and Team Carts in 32" (813 mm) and 48" (1219 mm) widths.

Item	Qty	Description
17	2	Wire-grille End Panel

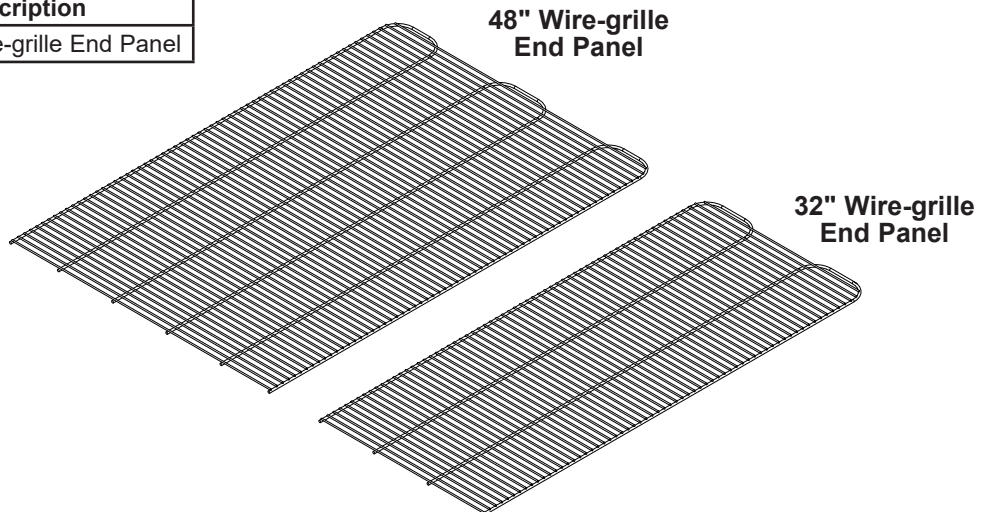

Parts Lists (continued)

Cart Hardware Pack Components

NOTICE
Applies to the Hardware Packs supplied with both X-Carts and Team Carts.

Item	Qty	Description
1	2	Pull Handle
2	2	Long "B" Knuckle
3	4	Frame Bumper
4	2	Half Lock "B" Knuckle
5	5	3/8 x 1-1/4" Flat Washer
6	13	3/8-16 Acorn Nut
7	5	1/4-14 x 1" Self-drilling Screw
8	13	3/8-16 x 1-1/4" Button Head Screw
9	1	3/8" Hex Nut Driver Bit
10	5	3/8-16 x 7/8" Button Head Screw
11	1	7/32" Hex Insert Bit

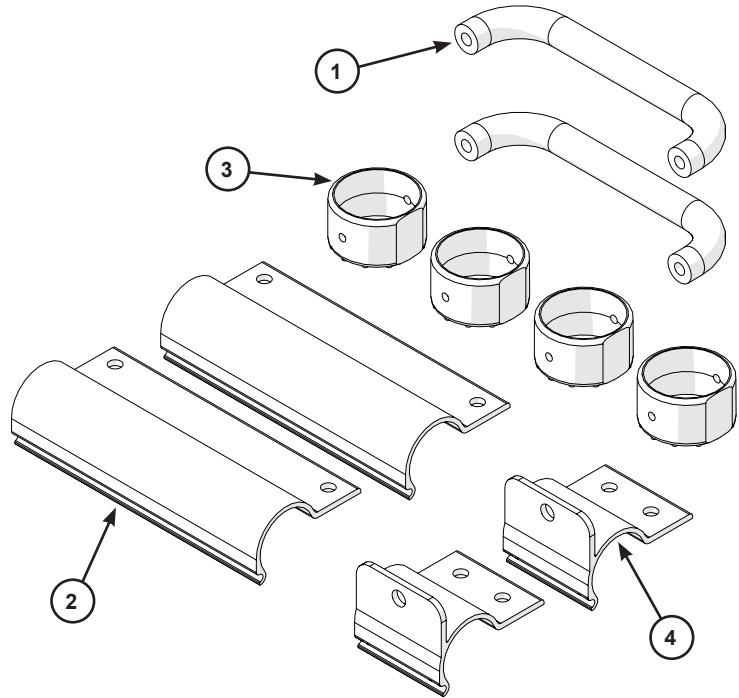

Cart Hardware Pack Supplied Hardware

NOTICE
Applies to the Hardware Packs supplied with both X-Carts and Team Carts.

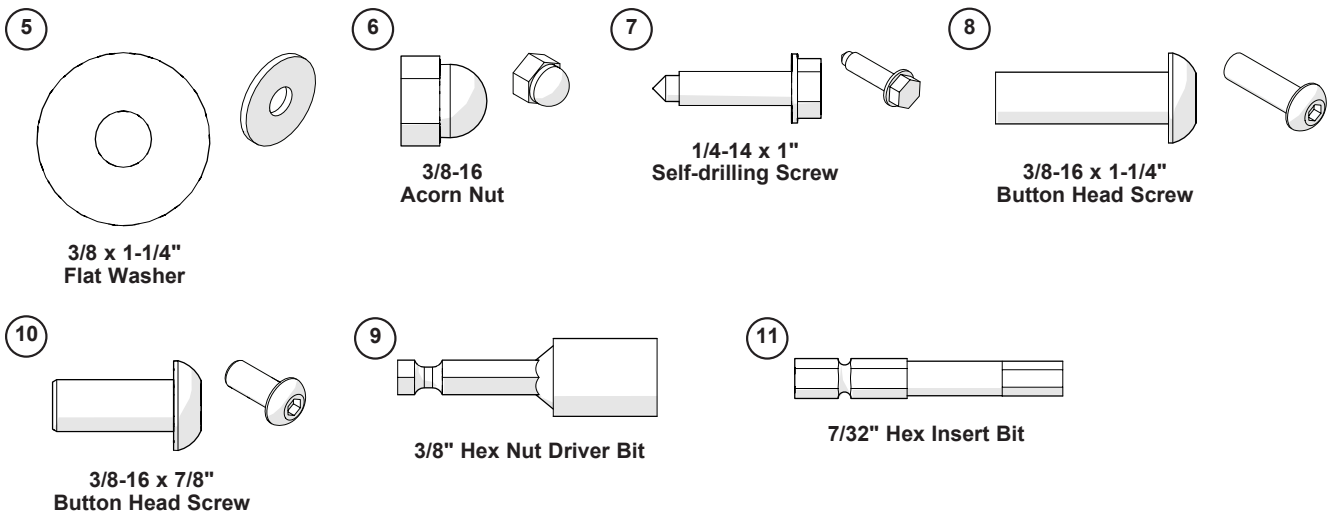

Parts Lists (continued)

Cart Knuckle Pack Components

NOTICE
Applies to the Hardware Packs supplied with both X-Carts and Team Carts.

Item	Qty	Description
41	8	Half "A" Knuckle
42	6	Half "B" Knuckle
43	2	Long "A" Knuckle

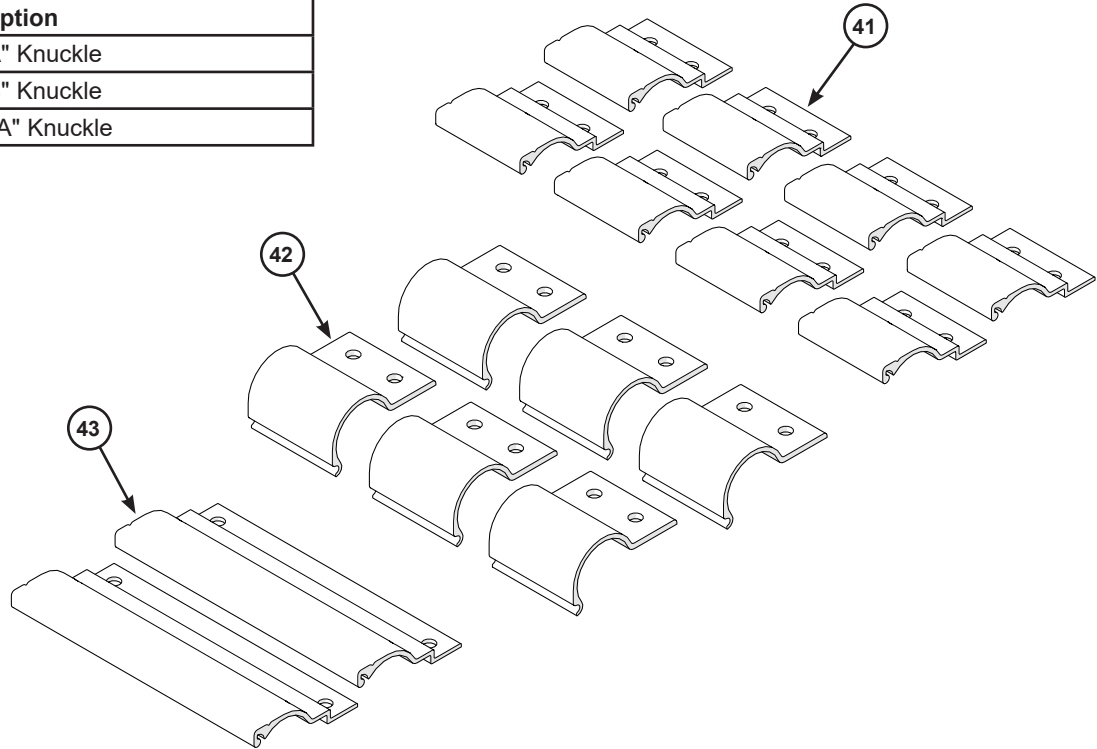

Cart Knuckle Hardware Pack Supplied Hardware

NOTICE
Applies to the Hardware Packs supplied with both X-Carts and Team Carts.

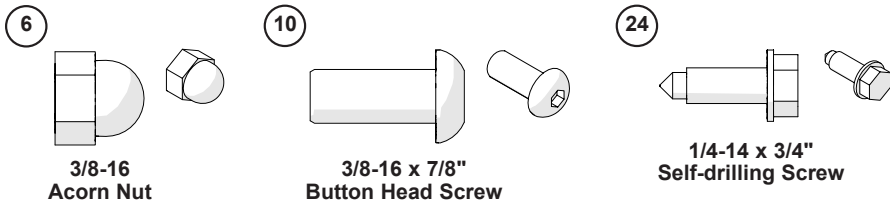

Parts Lists (continued)

NOTICE

The parts lists on this page apply to the components contained in the floor track cartons for use with the X-Carts and Team Carts.

Floor Track and Hardware

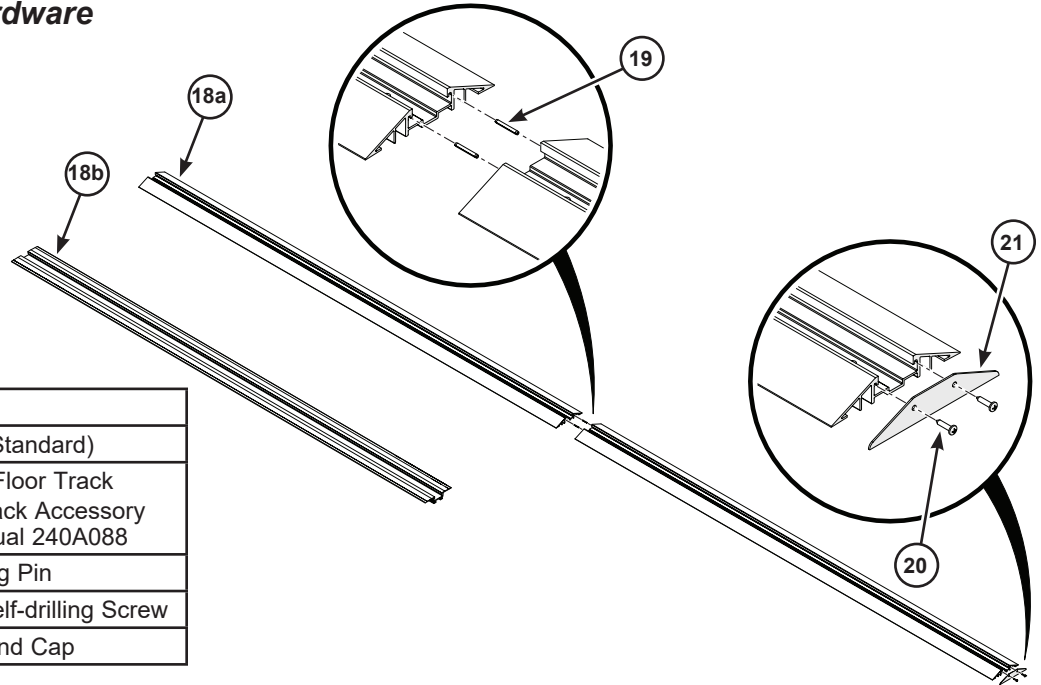

Item	Qty	Description
18a	1	Floor Track (Standard)
18b	1	Flush Mount Floor Track See Flush Track Accessory Owner's Manual 240A088
19	2	1/8 x 2" Spring Pin
20	2	8-18 x 3/4" Self-drilling Screw
21	1	Floor Track End Cap

Track Stop Bracket

Item	Qty	Description
22	1	Track Stop Bracket
23	1	Track Stop Bumper
24	2	1/4-14 x 3/4" Self-drilling Screw

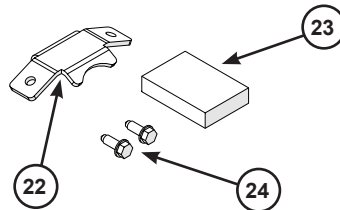

Adjustable Track Lock

Item	Qty	Description
26	1	Track Lock Pivot Weldment
27	1	Track Lock Bracket
28	1	Track Lock Toggle
29	1	Track Lock Handle

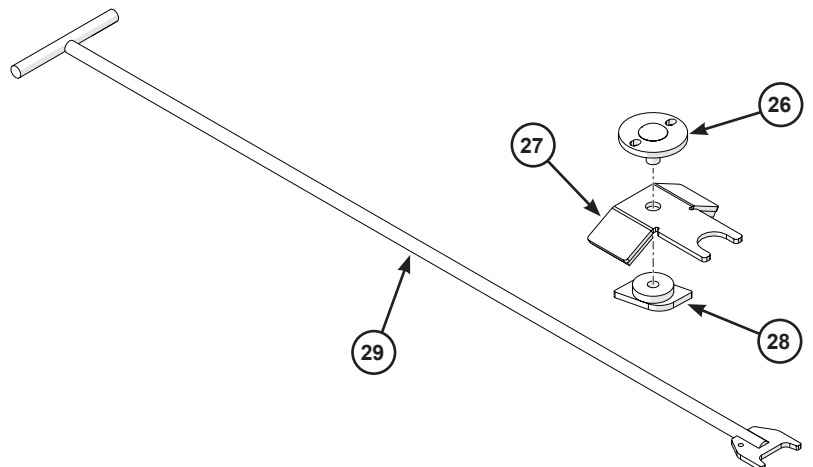

Description

X-Cart

On-the-track-only storage cabinet mounted on wheels in 32" (813 mm) and 48" (1219 mm) widths.

48" (1219 mm) X-Cart is shown.

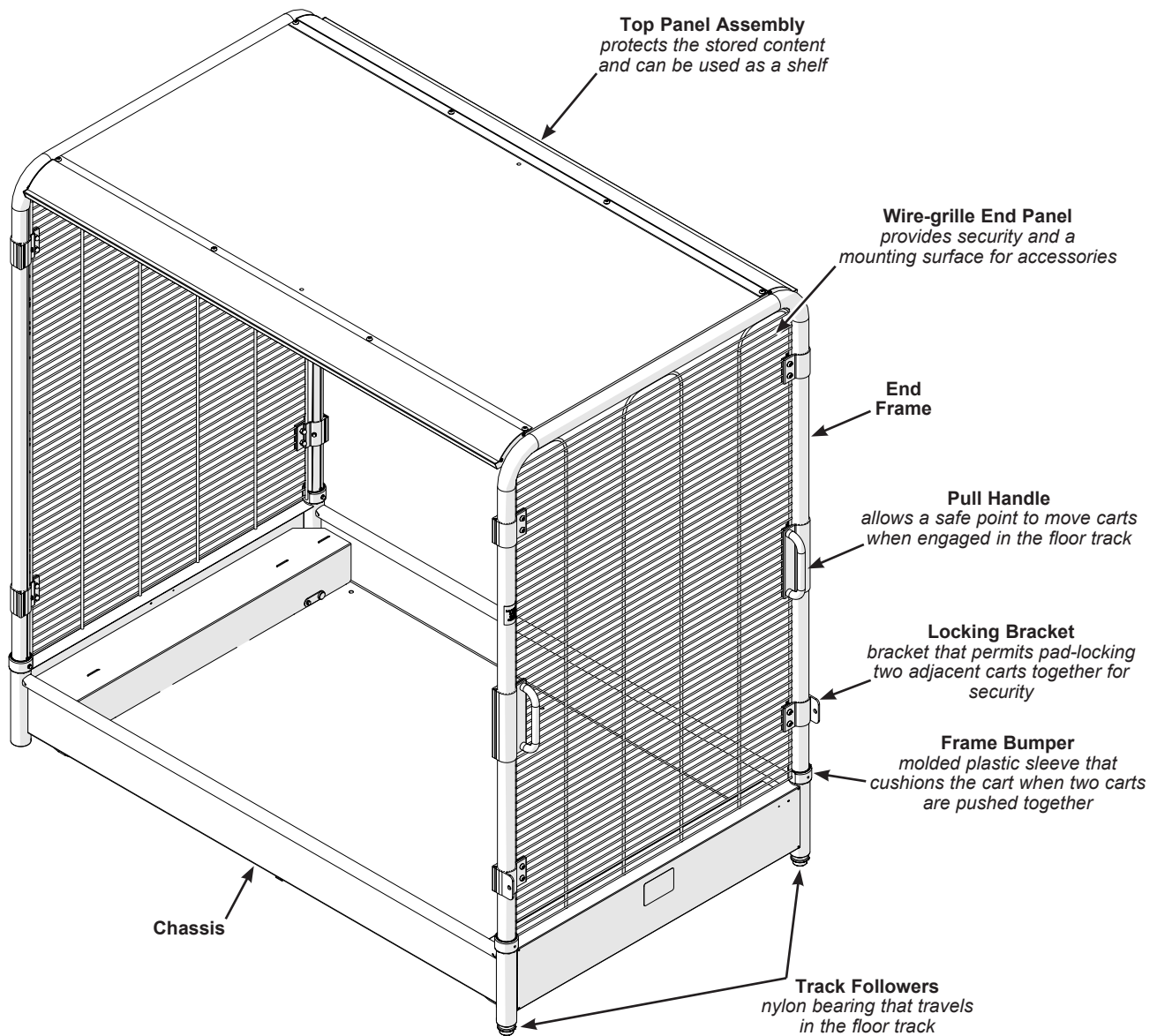

Description (continued)

Team Cart

On-the-track and transport-to-the-event-location storage cabinet mounted on swiveling casters in 32" (813 mm) and 48" (1219 mm) widths

32" (813 mm) Team Cart is shown.

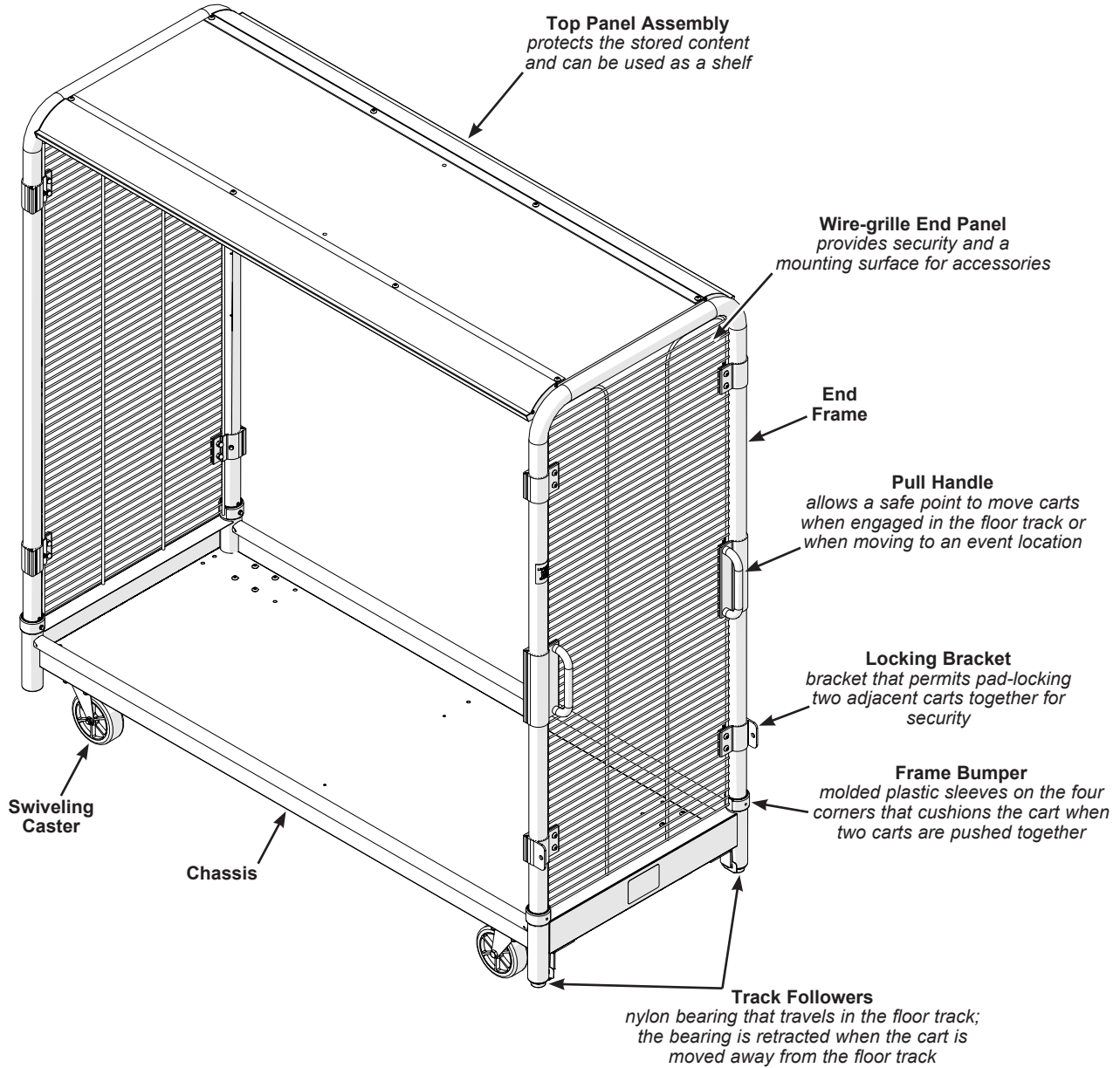

Description

Floor Track

Available as Standard or Flush Mount.

For flush mount track, see Flush Track Accessory Owner's Manual 240A088.

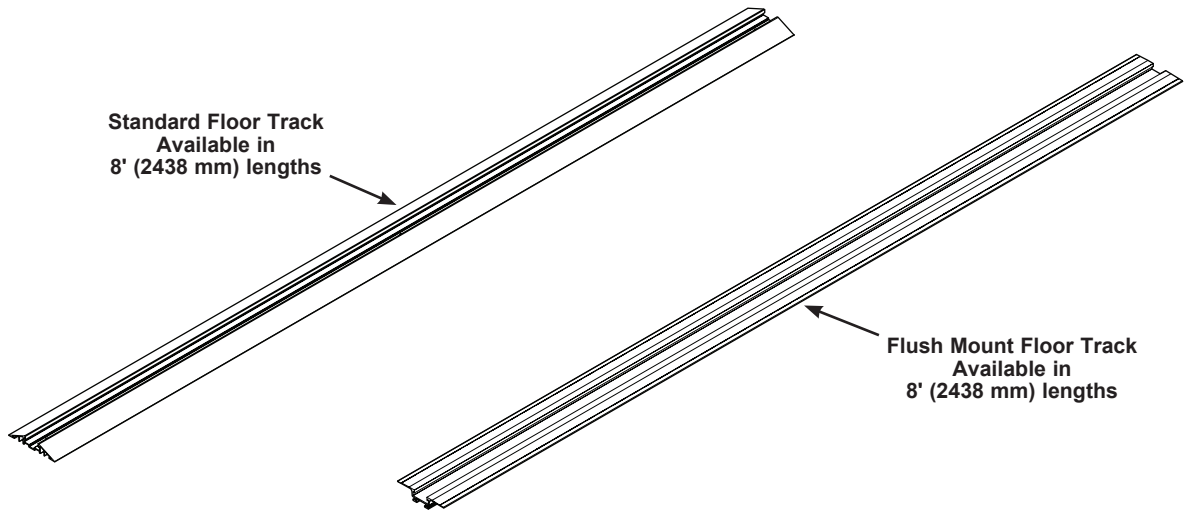

Track Stop and Adjustable Track Lock

Available on either Standard or Flush Mount.

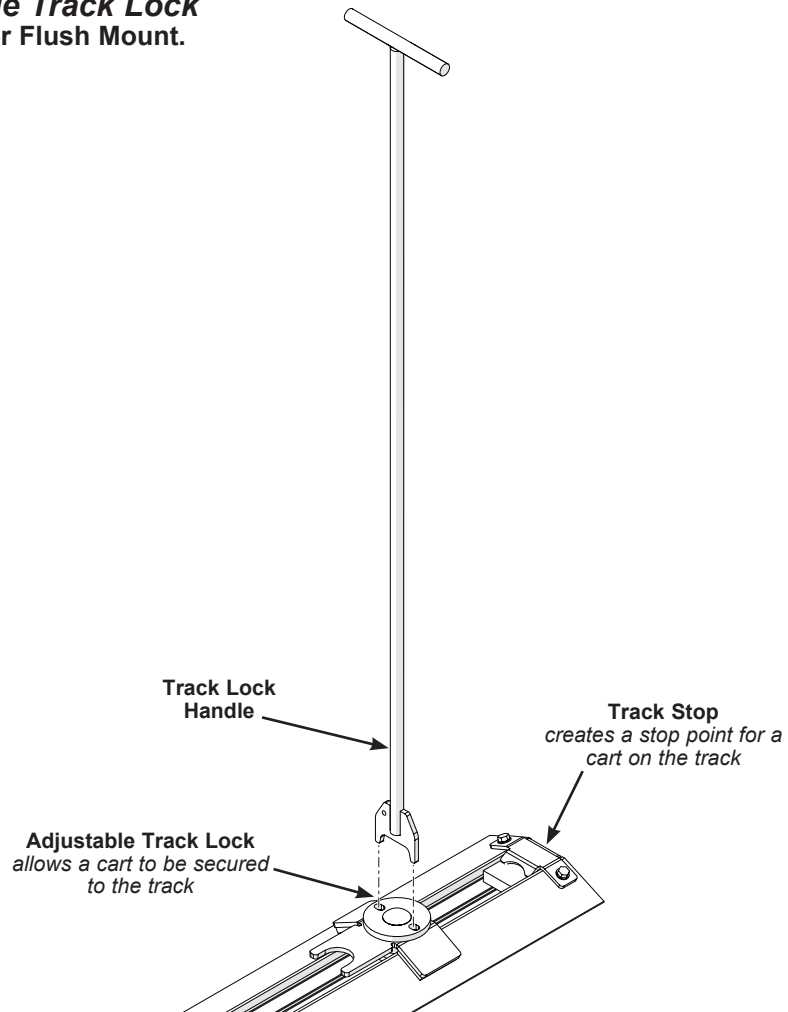

Required Tools

The following tools are recommended for installation and assembly.

Cart Assembly

- Drill
- 9/16" Combination wrench
- Phillips drive bit or screwdriver
- Mallet

Floor Track Installation

- Plumb bob
- 50' Chalk line
- Tape measure
- Pencil

Load Capacity

Item	Capacity
Cabinet top panel, uniform static load	150 lb (68 kg)
32" (813 mm) or 24" (610 mm) shelf, uniform static load	150 lb (68 kg)
32" (813 mm) shelf	18 Helmets
24" (610 mm) shelf	12 Helmets
Helmet hanger	8 Helmets
Shoulder pad stacker	22 Shoulder pads

Maintenance

1. Keep the floor track clear of dirt and trash.
2. Keep the floor area between the floor track and the rear wall clear of clothing, equipment and trash.
3. Clean high-density sports storage system component surfaces with a mild detergent. Do not use harsh abrasive cleaning products.
4. Make sure that all fasteners are tight.
5. Replace any damaged parts such as wheels, casters, or track followers immediately.

Standard Floor Track Installation



This is the procedure for installing the standard floor track.
For flush mount track installation, see Flush Track Accessory Owner's Manual 240A088

Before Starting the Assembly

Before installing, do the following.

1. All personnel, including temporary personnel, must read and understand these instructions.
2. Inventory the cartons and make sure that all required components are present.
3. When each carton is opened, inventory the components and hardware packages and make sure that everything is present.

CAUTION

Some components can be very heavy, large and awkward to handle. Serious injury or property damage can happen if only one person attempts to move or lift some components such as a chassis.

Two or more people must always work together when lifting or moving heavy components.

NOTICE

Not all hardware items packed in the carton may be needed.

When the assembly is complete, any unused hardware can be discarded.

Layout the Space

Refer to the illustration on the next page.

1. Before starting the installation, move the cartons close to the location where the system will be installed. Refer to any architectural drawings that were supplied by Wenger Corporation or a contractor.
2. Strike a chalk line on the floor that will locate the centerline of the floor track as follows.

NOTICE

When locating the floor track centerline, always make sure there will be 1" (25 mm) of clearance on the rear side of the cart. With 1" (25 mm) clearance, the floor track centerline should be located 78" (1981 mm) from the wall or an obstruction.

Make sure that no obstructions lower than the top of the cart plus 1" (24 mm), 80" (2032 mm) for the cart without an attic accessory, 106" (2692 mm) for a cart with a short attic accessory, and 118" (2997 mm) for a cart with a tall attic accessory] are within the perimeter of the floor track, side walls, and rear wall. If an obstruction is within this perimeter and is lower than the top of cart assembly, movement will be impaired and the floor track placement must be adjusted.

When obstructions prevent full cart movement within the perimeter, use a plumb bob to mark the rear position of the cart movement area. Refer to the illustration on the next page. Measure 78" (1981 mm) from these rear marks to locate the floor track centerline.

If more than 1" (25 mm) of clearance is desired, move the floor track centerline further from the wall.

- a. Using a tape rule, measure from the rear wall or obstruction and make a mark on the floor 78" (1981 mm) from the rear wall or obstruction and several feet from a side wall.
- b. Make another mark on the floor 78" (1981 mm) from the rear wall or obstruction and several feet from the opposite side wall.
- c. Strike a chalk line through the two floor marks from one side wall to the opposite side wall.

Standard Floor Track Installation (continued)

Layout The Space (continued)

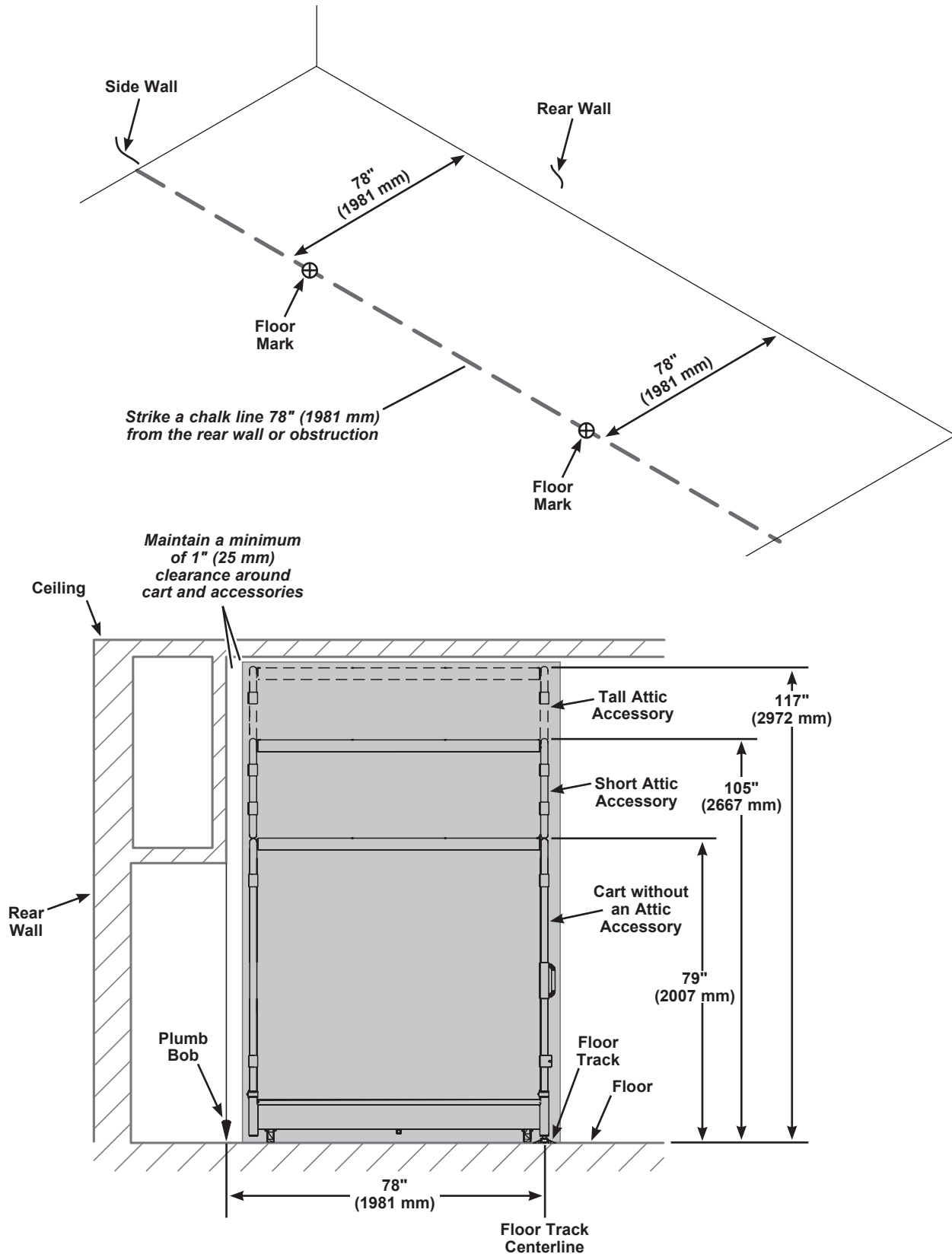

Standard Floor Track Installation (continued)

Attach Floor Track to Floor

Standard floor track sections are 8' (2438 mm) long.

To achieve the required floor track length, additional sections may be joined together or trimmed as needed.

The floor track (18a) is attached to the floor surface by anchoring it with the appropriate fasteners at the pilot holes in the floor track. Each 8' section has three pilot holes.

To attach the Standard floor track:

1. If a floor track end will be exposed, attach the end cap (21) to the exposed end of the floor track using two 8-18 x 3/4" self-drilling screws (20) as shown.

If neither floor track end will be exposed, the end cap and screws can be discarded.

2. Place a floor track section onto the chalk line with one end against the side wall and align the three pilot holes so the chalk line is visible through each hole.
3. Use the floor track as a template and mark the location of the three holes with a pencil.
4. Using the appropriate fasteners, anchor the floor track to the floor at the three marks.

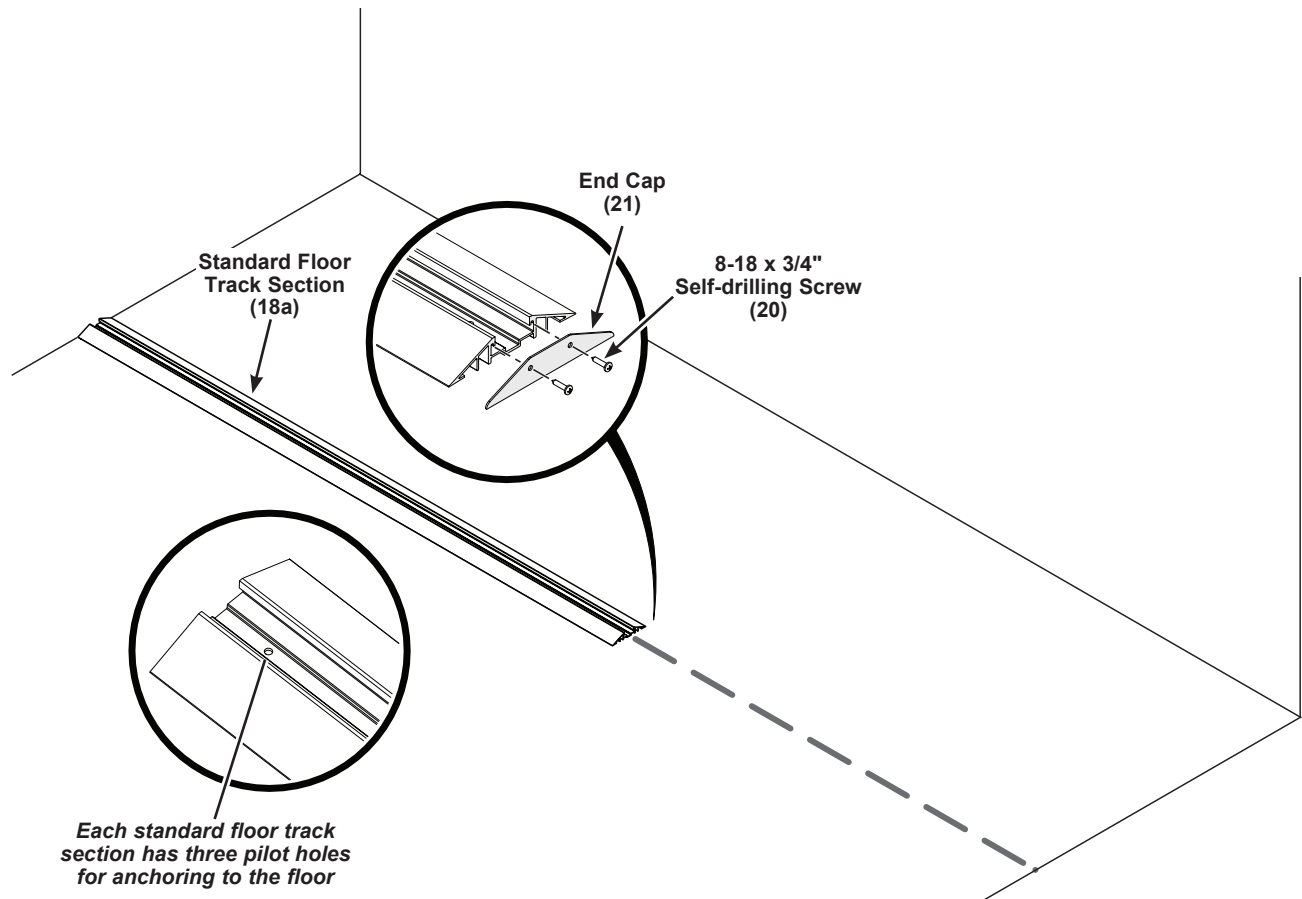

Standard Floor Track Installation (continued)

Attach Floor Track to Floor (continued)

5. Anchor additional floor track sections as needed.
 - a. Using a mallet, drive two spring pins half way into the two floor track screw channels on the end of the anchored floor track.

NOTICE

Take care to not bend the spring pins when driving the track onto the pins.

- b. Place the next floor track section onto the floor and align the floor track screw channels to the spring pins in the anchored floor track.

NOTICE

Each floor track has a set of warning decals on one end.

Always place the floor track end with a warning decal next to the floor track end without a warning decal.

- c. Use a mallet and a block of wood and tap the floor track section onto the anchored floor track spring pins.
 - d. Anchor the floor track section to the floor by repeating steps 2-4.
6. Anchor additional floor track sections as required.
 - a. If the end of the floor track is exposed, attach the end cap using two 8-18 x 3/4" self-drilling screws as shown in step 1 before anchoring it to the floor.
 - b. If the last floor track section is too long, cut the floor track to the correct length and discard the unused piece of track. Use a file to remove any burrs from the cut end of the floor track.

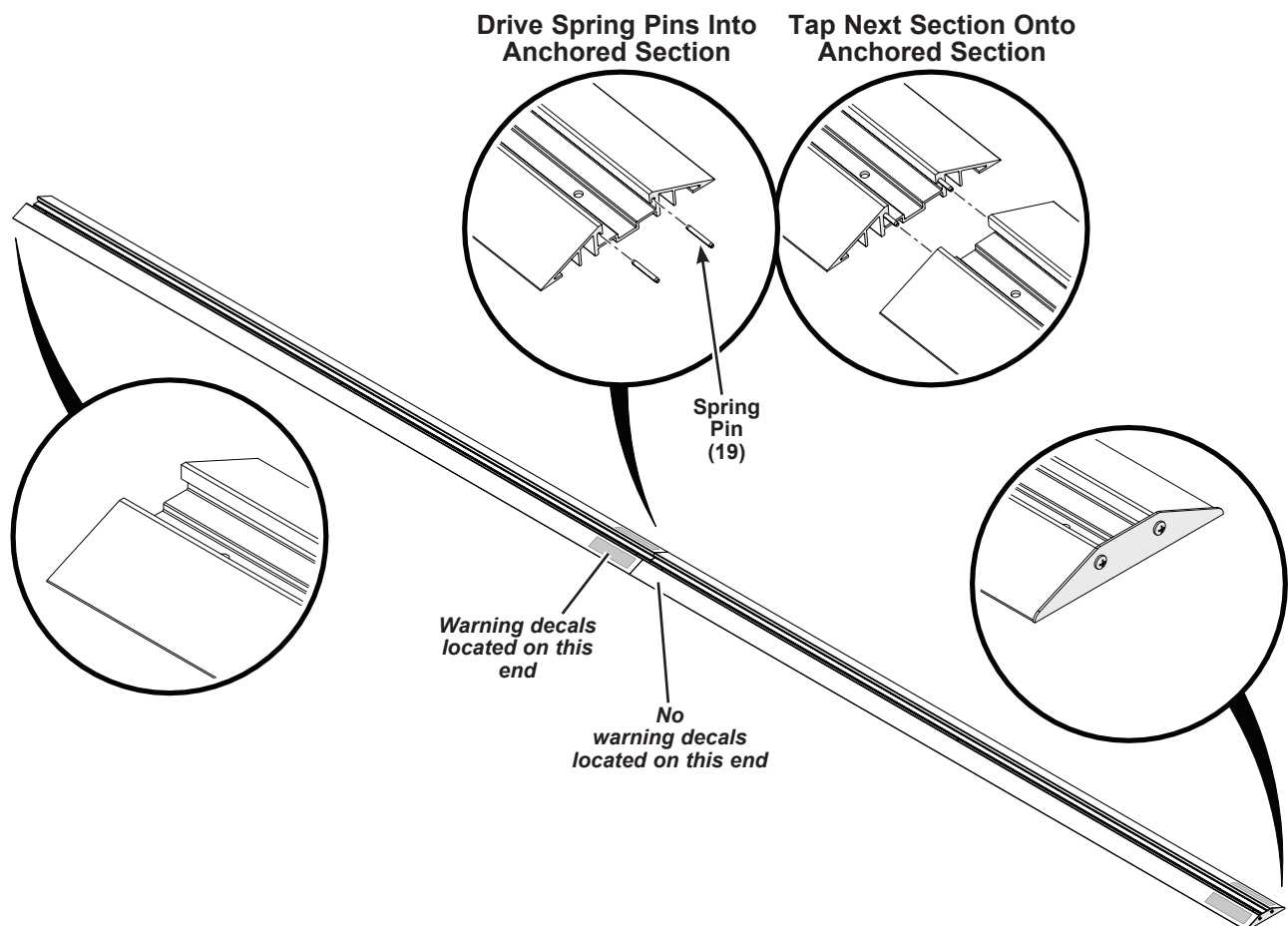

Track Stop Bracket Accessory Installation



The track stop bracket is an optional accessory, skip this procedure if not installing.

1. Place the track stop bumper (23) into the channel of the installed floor track at the desired stop point for the cart.

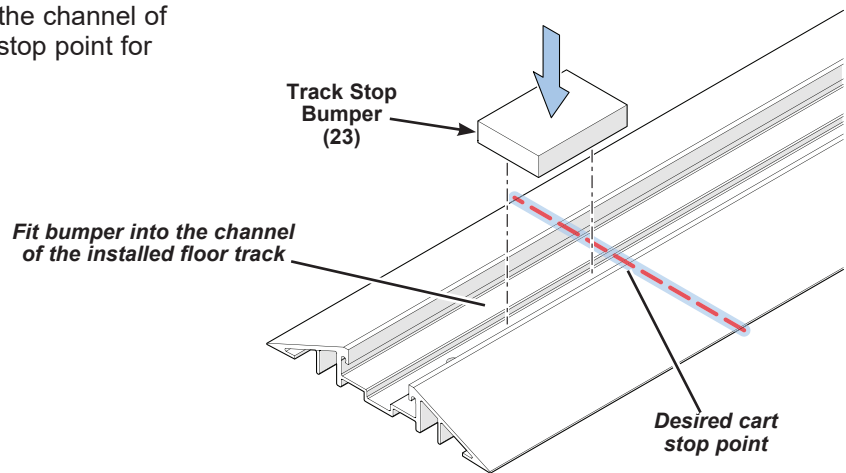

2. Fit the track stop bracket (22) onto the bumper so the tab covers the other end of the bumper
3. Secure it tight against the floor track using two 1/4-14 x 3/4" self-drilling screws (24) as shown.

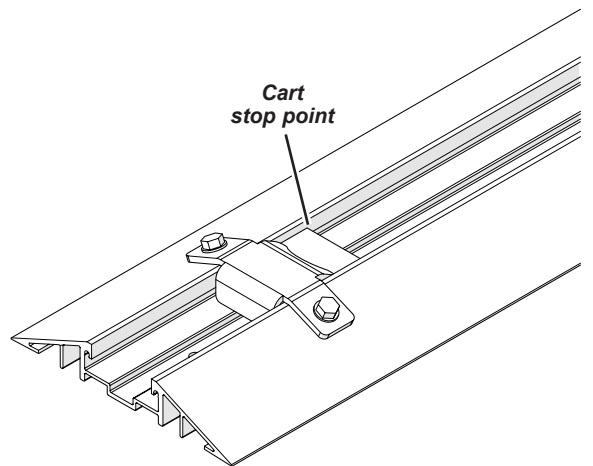
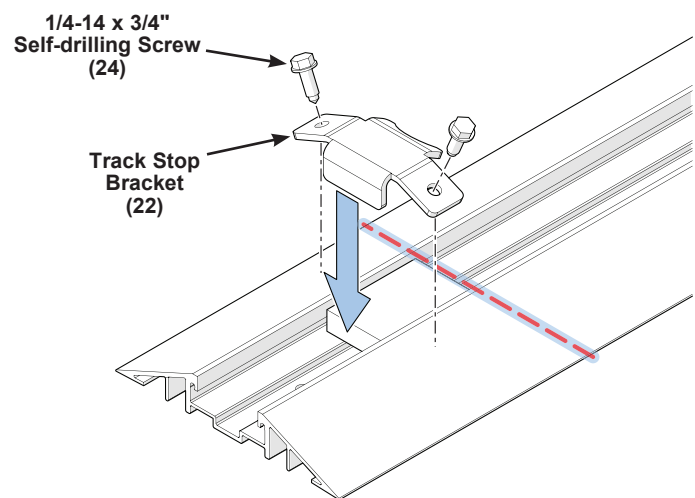

Track Stop Bracket Installed

Adjustable Track Lock Accessory Operation



The adjustable track lock bracket is an optional accessory, skip this procedure if not installing.

NOTICE

There are two versions of the adjustable track lock assembly:

The track lock bracket for a standard floor track is bent to fit flush.

The track lock bracket for a flush floor track is flat to fit flush.

1. To install the track lock:

Place the adjustable track lock assembly into the channel of the installed floor track at the desired stop point for the cart as shown.

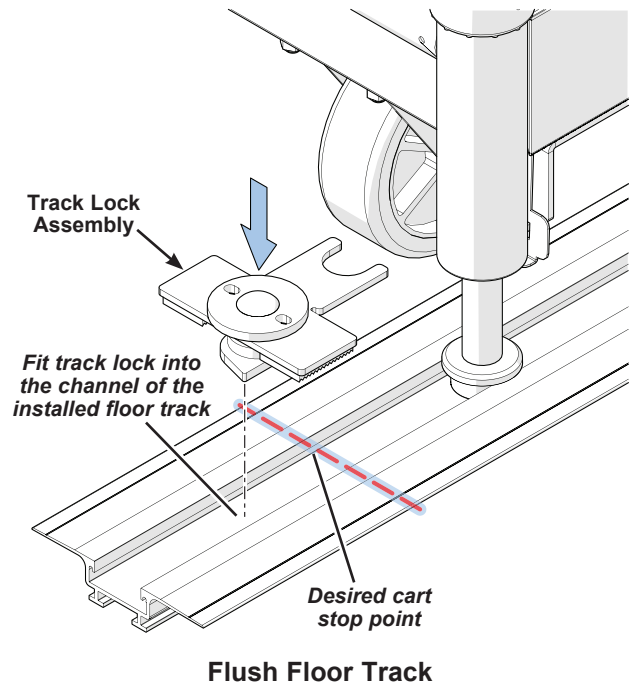
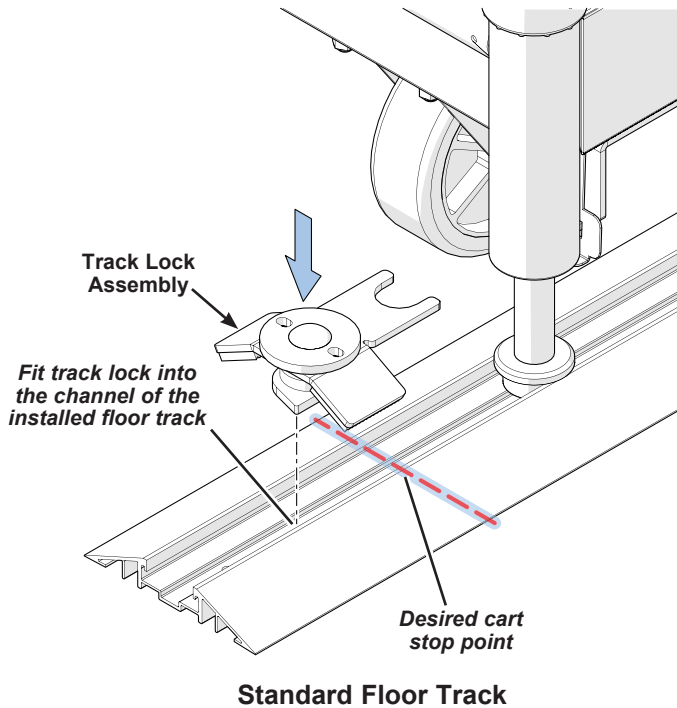

Adjustable Track Lock Accessory Operation (continued)

2. To lock the track lock:

Slide the cart into the track lock and insert the track lock handle (29) into the track lock pivot weldment and rotate it clockwise to lower it onto the track follower until the cart is secure in place.

NOTICE

When turning the track lock pivot weldment, be sure that the track lock toggle rotates into the lock position and that the flanges are positioned under the channel in the track prior to tightening.

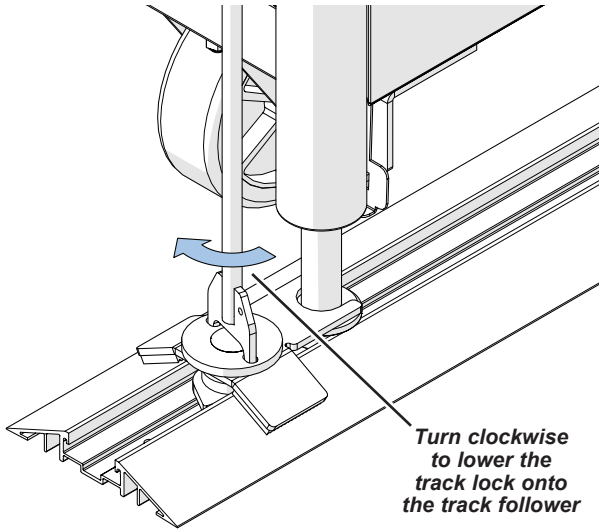

Standard Floor Track

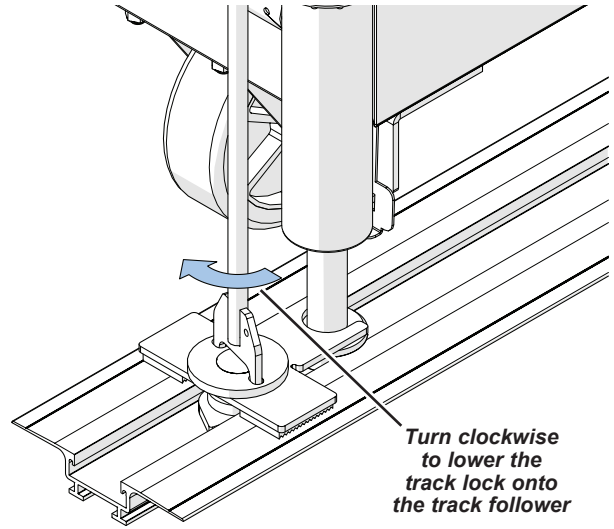

Flush Floor Track

3. To unlock the track lock:

Insert the track lock handle (29) into the track lock pivot and rotate it counter-clockwise to raise it off of the track follower until the track lock loosens and the cart can be moved.

NOTICE

It is not necessary to separate the track lock toggle from the track lock pivot weldment.

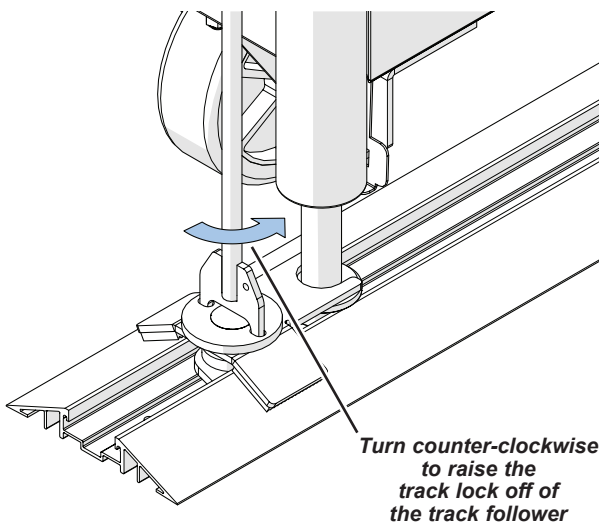

Standard Floor Track

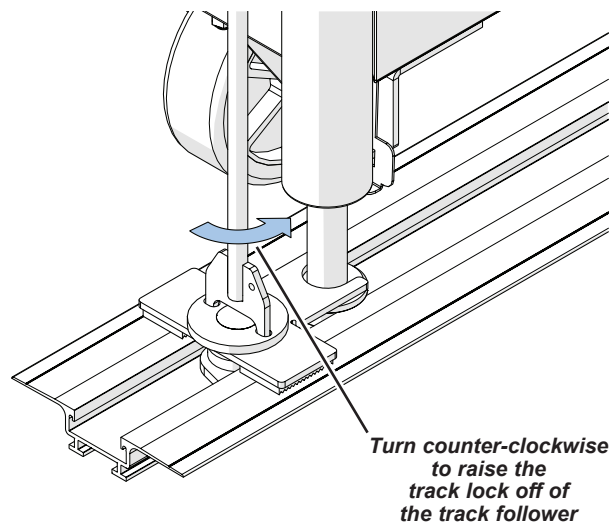

Flush Floor Track

Cart Assembly



*This is the procedure for attaching wheels to an X-Cart!
For attaching casters to a Team Cart, go to the following page.*

Attach Wheels to an X-Cart

1. Attach a wheel (33) to each corner of the chassis (14).
 - a. Fit a wheel into the slot at the bottom side of the chassis and align the center hole with the holes in the top side of the chassis.
 - b. Insert an axle pin (34) through the chassis and the center of the wheel and secure it to the chassis using a 1/4-14 x 3/4" self-drilling screw (35).

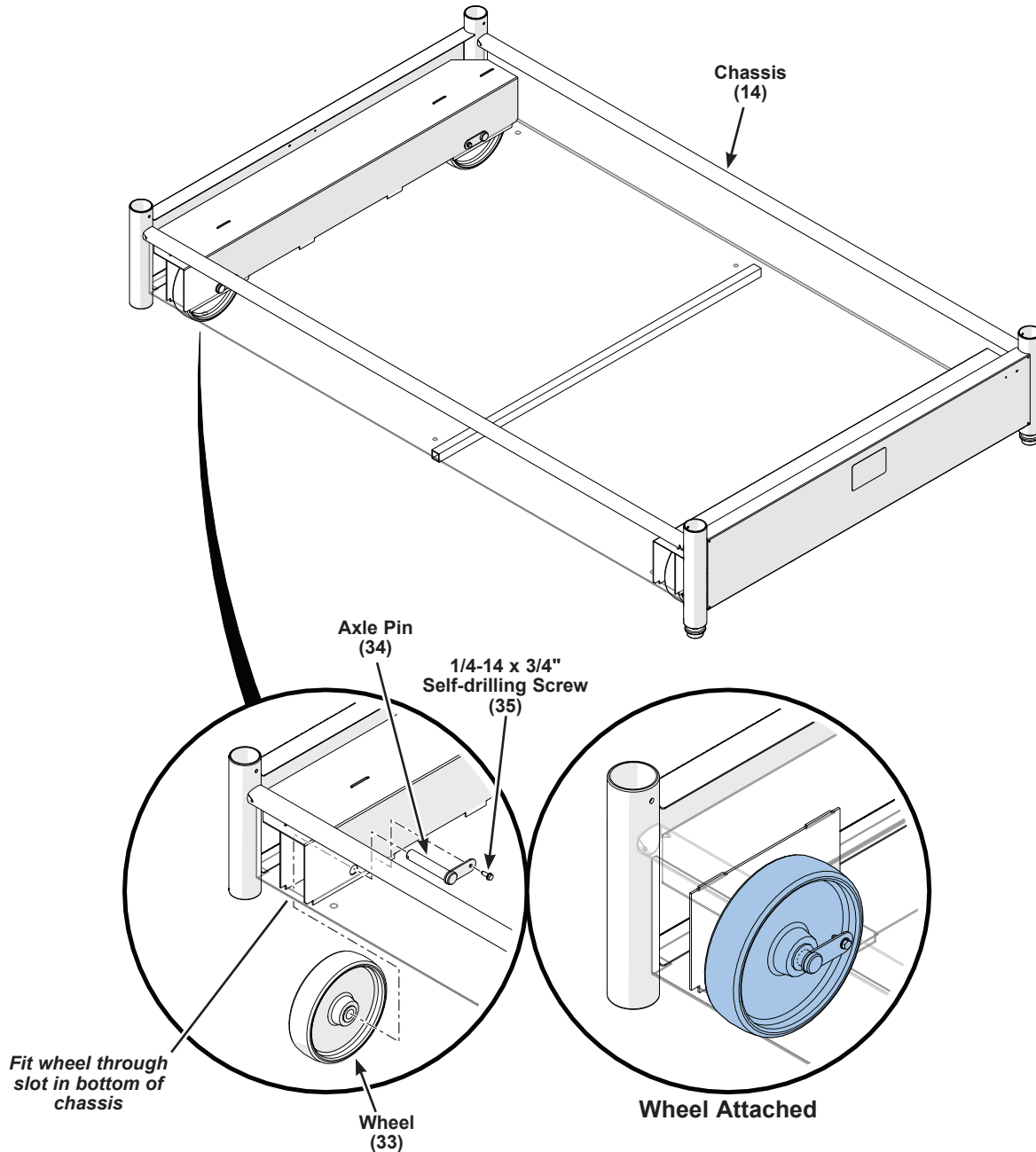

Cart Assembly (continued)



*This is the procedure for attaching casters to a Team Cart!
For attaching wheel bearings to an X-Cart, go to the previous page.*

Attach Casters to a Team Cart

1. Attach a caster (38) to the bottom side of each corner of the chassis (14) using four 3/8-16 x 3/4" button head screws (39) and 3/8-16 lock nuts (37) in each.

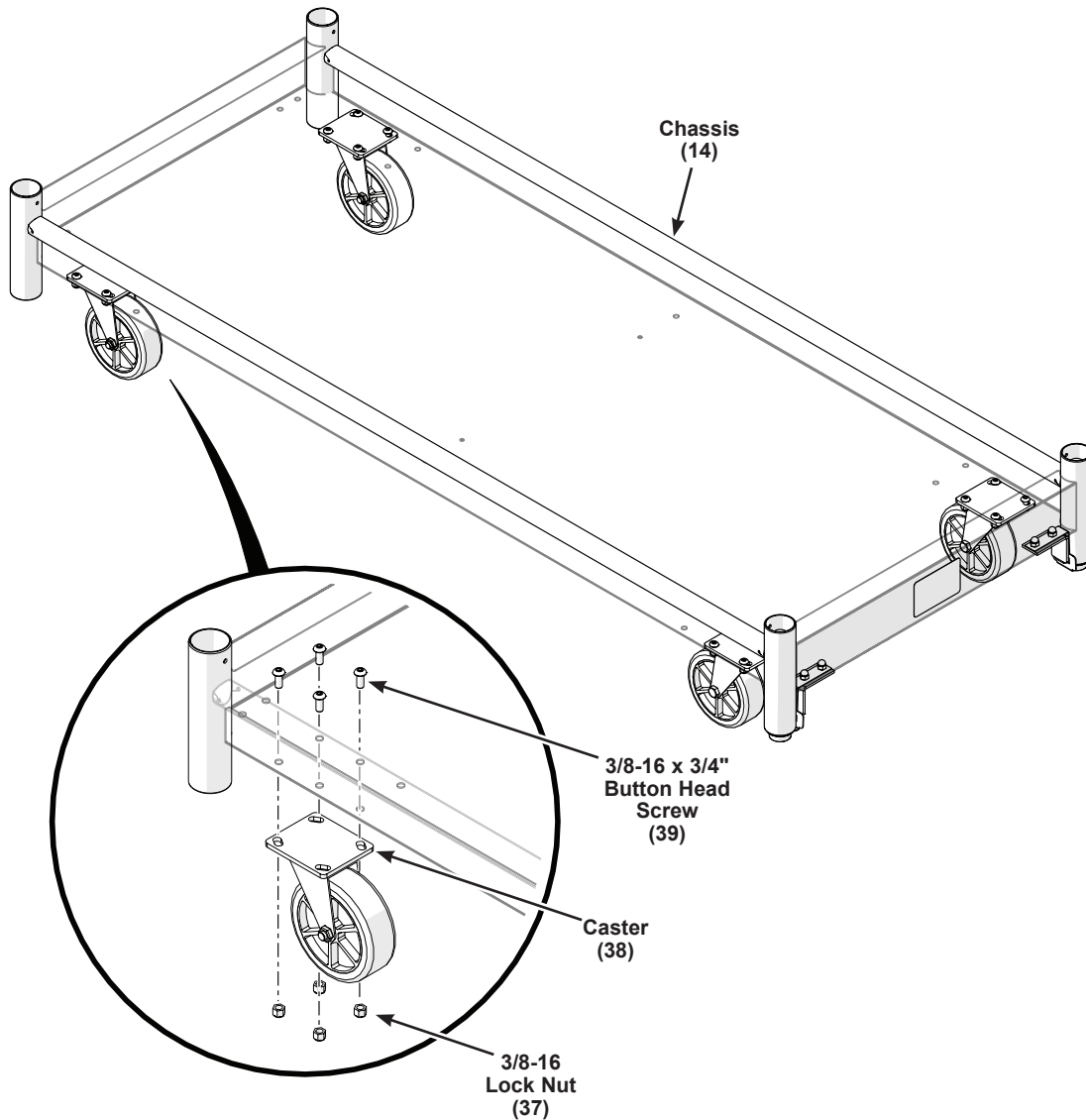

Cart Assembly (continued)

Place Frame Bumpers

1. Attach a frame bumper (3) to each of the four end frame posts on the chassis.

For each frame bumper, turn the flat surface to face inside and align the pilot hole in the frame bumper with the pilot hole the chassis end frame post as shown.

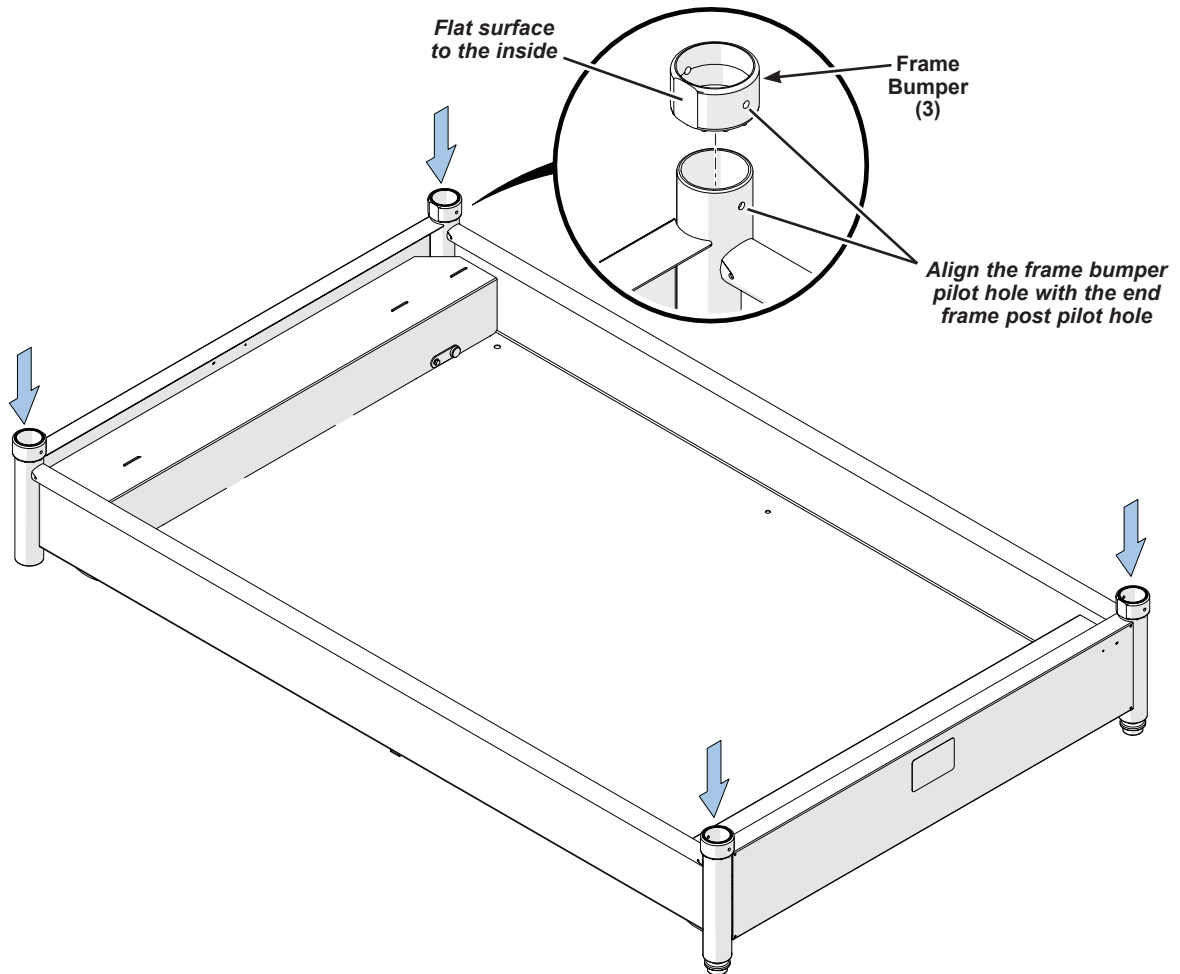

Cart Assembly (continued)

Assemble Front End Frame

NOTICE

The only difference between the front and rear end frame assemblies is that the caution decal is located on the front end frame post (see below).

1. Lay the front end frame assembly (12) flat with the top ledge facing up and the decal side facing down.
2. Attach a half "a" knuckle (41) toward the top and bottom of each front end frame post using a 1/4-14 x 3/4" self-drilling screw (24) in each as shown.

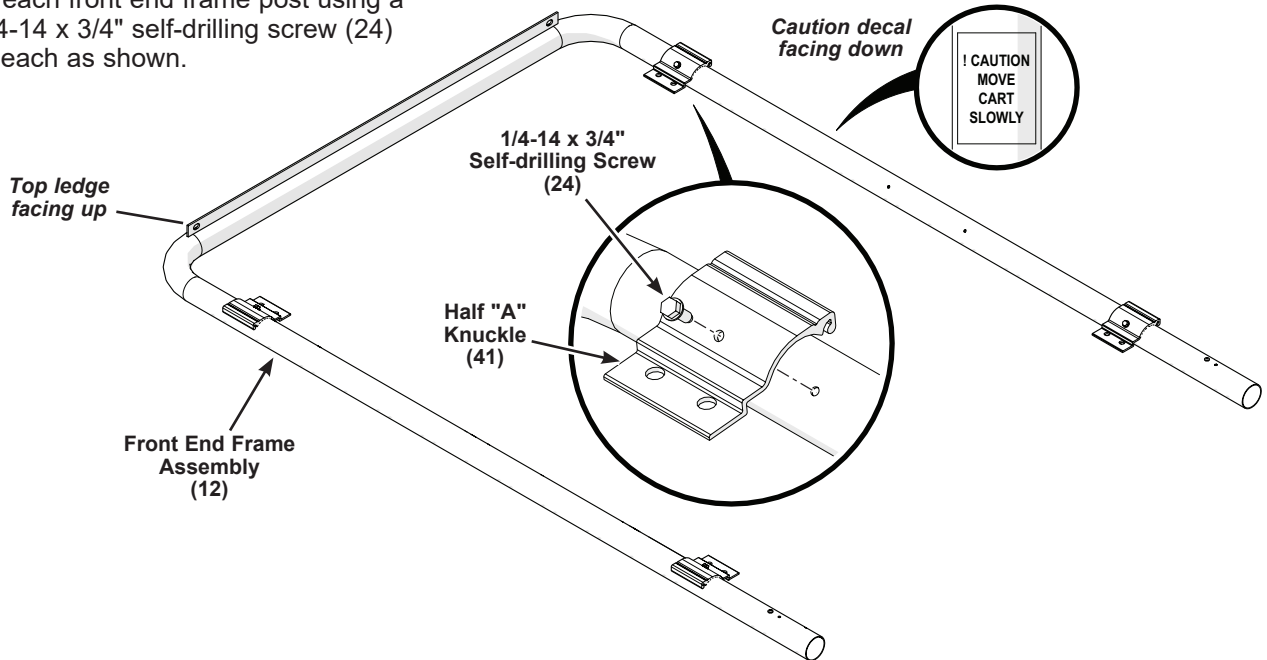

3. Attach a long "a" knuckle (43) to each front end frame post using two 1/4-14 x 3/4" self-drilling screws (24) in each as shown.

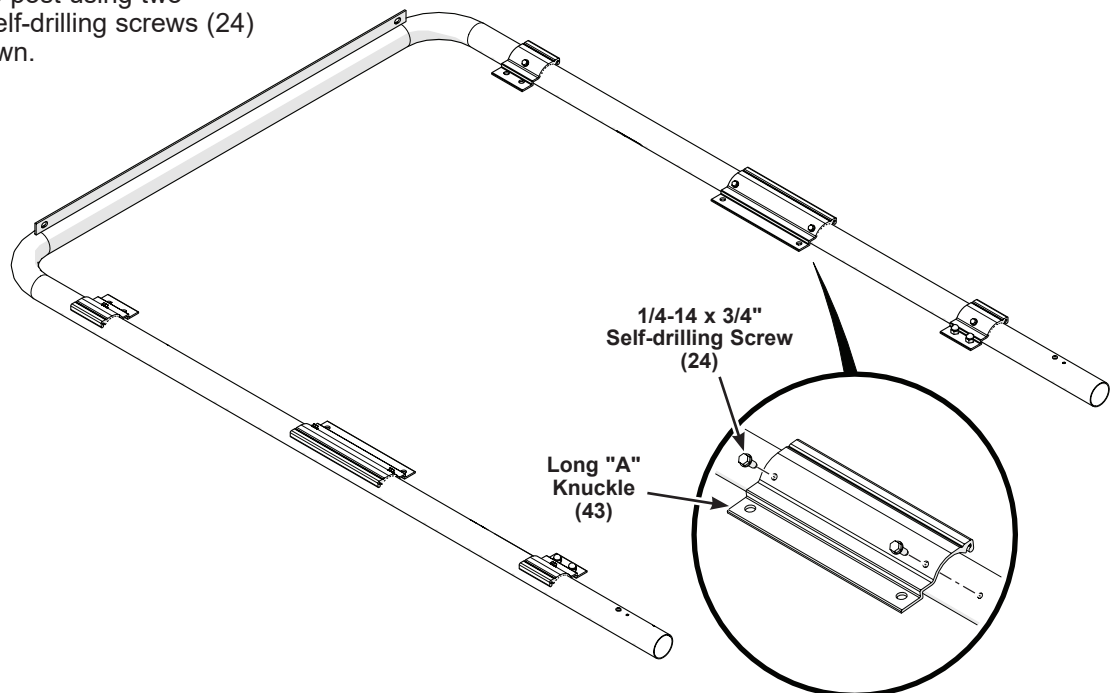

Cart Assembly (continued)

Assemble Front End Frame (continued)

- Turn the front end frame assembly over.
- With the horizontal wires facing up**, position the wire-grille end panel (17) to fit onto the attached "a" knuckles (41) and approximately 1/4" (6 mm) below the end frame horizontal tube.

NOTICE

The top wire of the wire-grille should be approx. 1/4" (6 mm) below the horizontal tube and facing up.

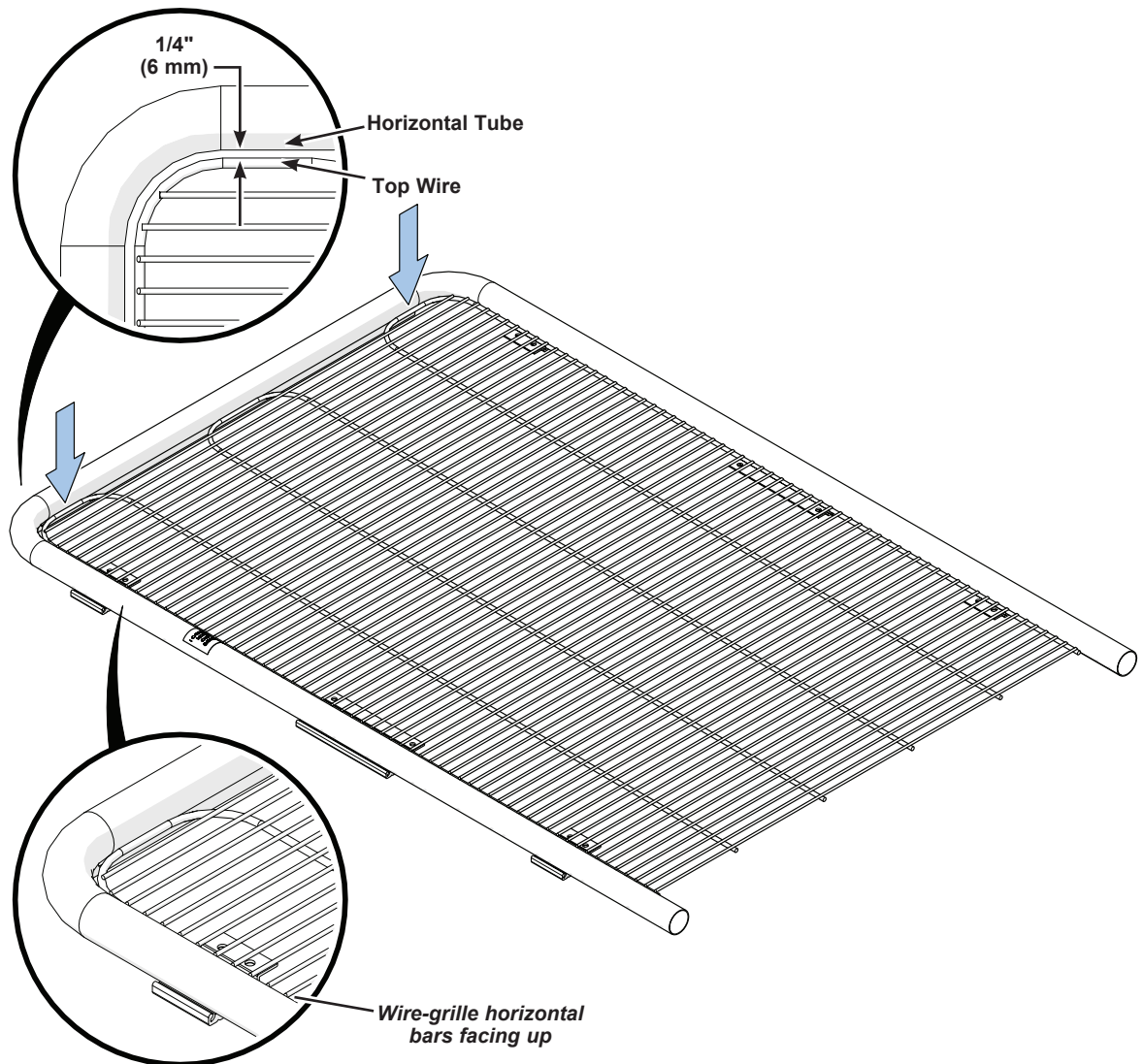

Cart Assembly (continued)

Assemble Front End Frame (continued)

6. Attach half "b" knuckles to the top pair of installed half "a" knuckles.

- a. Engage the slot of a half "b" knuckle (42) with the post of an attached half "a" knuckle.
- c. While maintaining the 1/4" (6 mm) wire-grille space at the top and aligning the horizontal wires to clear the open pilot holes in the knuckles, rotate it to close over the end frame post.
- b. Attach the half "b" knuckle to the half "a" knuckle using two 3/8-16 x 7/8" button head screws (10) and 3/8-16 acorn nuts (6).

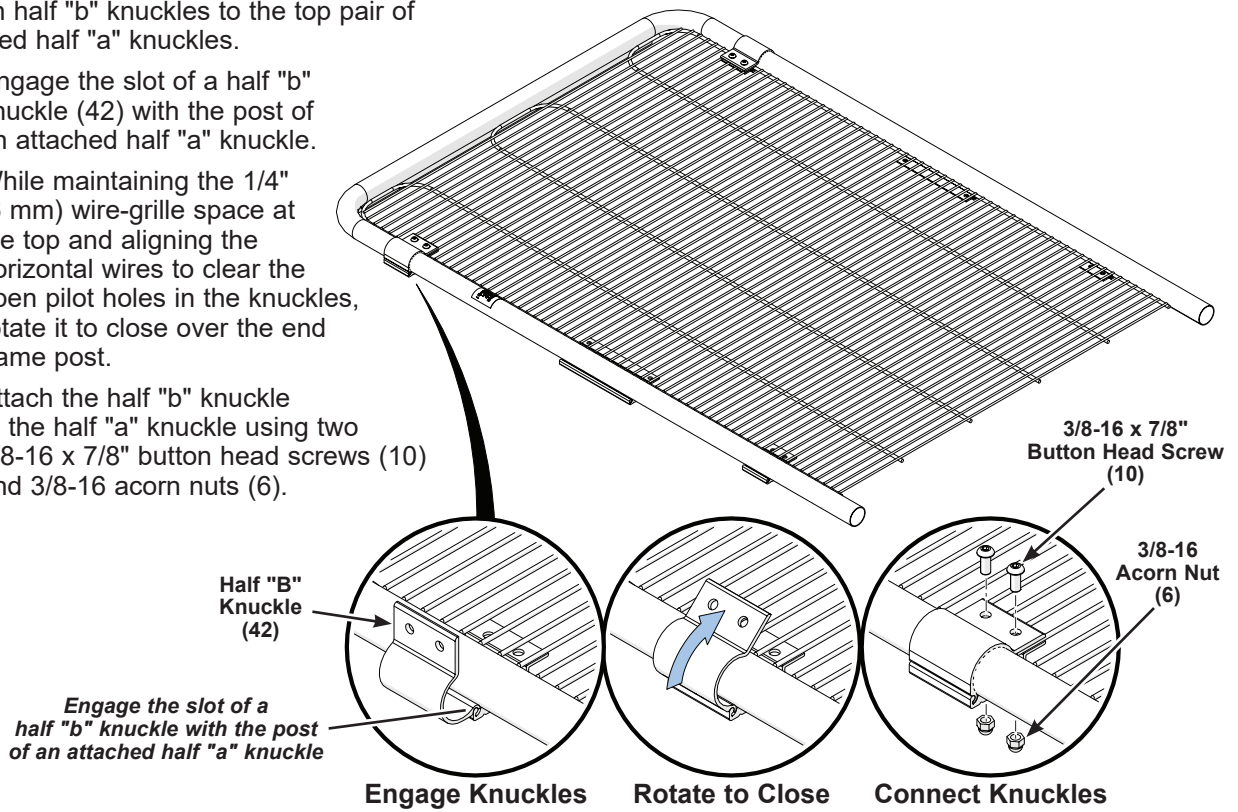

7. Attach half lock "b" knuckles to the bottom pair of installed half "a" knuckles.

- a. Engage the slot of a half lock "b" knuckle (4) with the post of an attached half "a" knuckle.
- c. While maintaining the 1/4" (6 mm) wire-grille space at the top and aligning the horizontal wires to clear the open pilot holes in the knuckles, rotate it to close over the end frame post.
- b. Attach the half lock "b" knuckle to the half "a" knuckle using two 3/8-16 x 7/8" button head screws (10) and 3/8-16 acorn nuts (6).

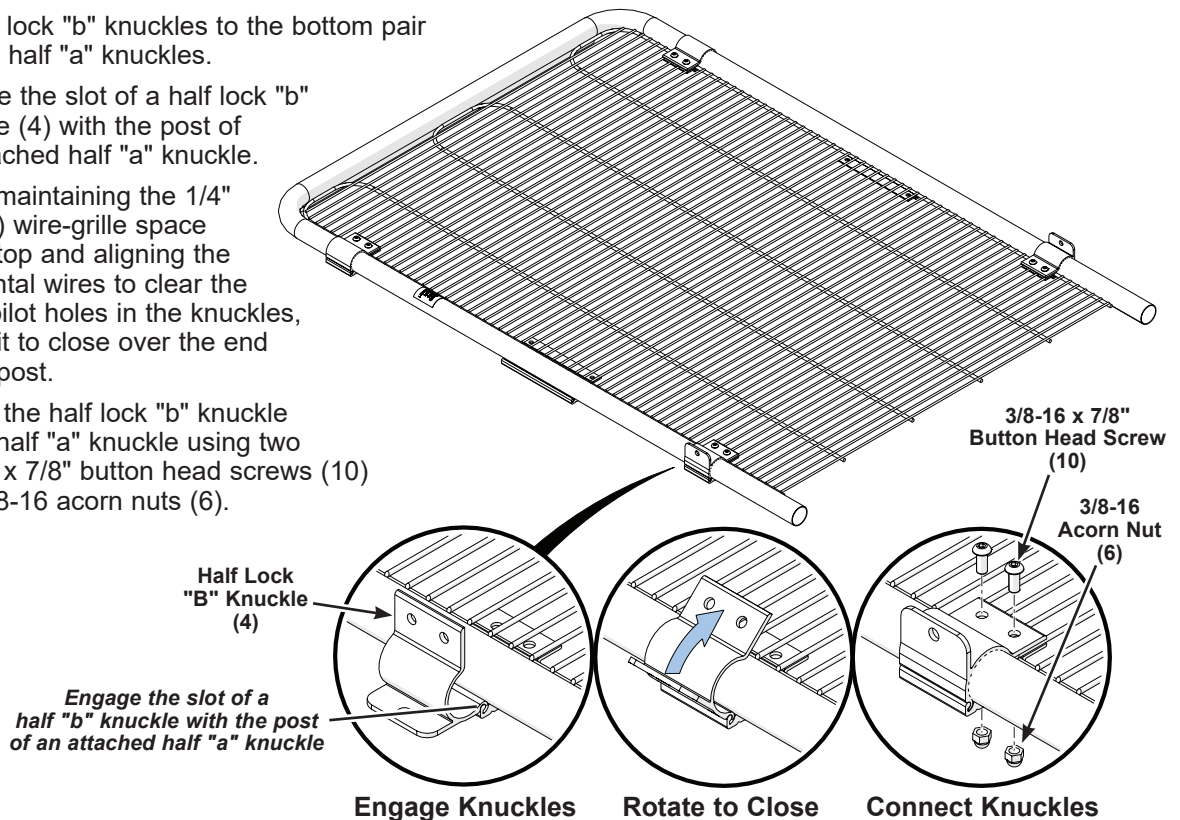

Cart Assembly (continued)

Assemble Front End Frame (continued)

8. Attach long "b" knuckles and pull handles to the middle pair of installed half "a" knuckles.

- Engage the slot of a long "b" knuckle (2) with the post of an attached long "a" knuckle.
- While maintaining the 1/4" (6 mm) wire-grille space at the top and aligning the horizontal wires to clear the open pilot holes in the knuckles, rotate it to close over the end frame post.
- Attach a pull handle (1) and the long "b" knuckle to the long "a" knuckle using two 3/8-16 x 1-1/4" button head screws (8).

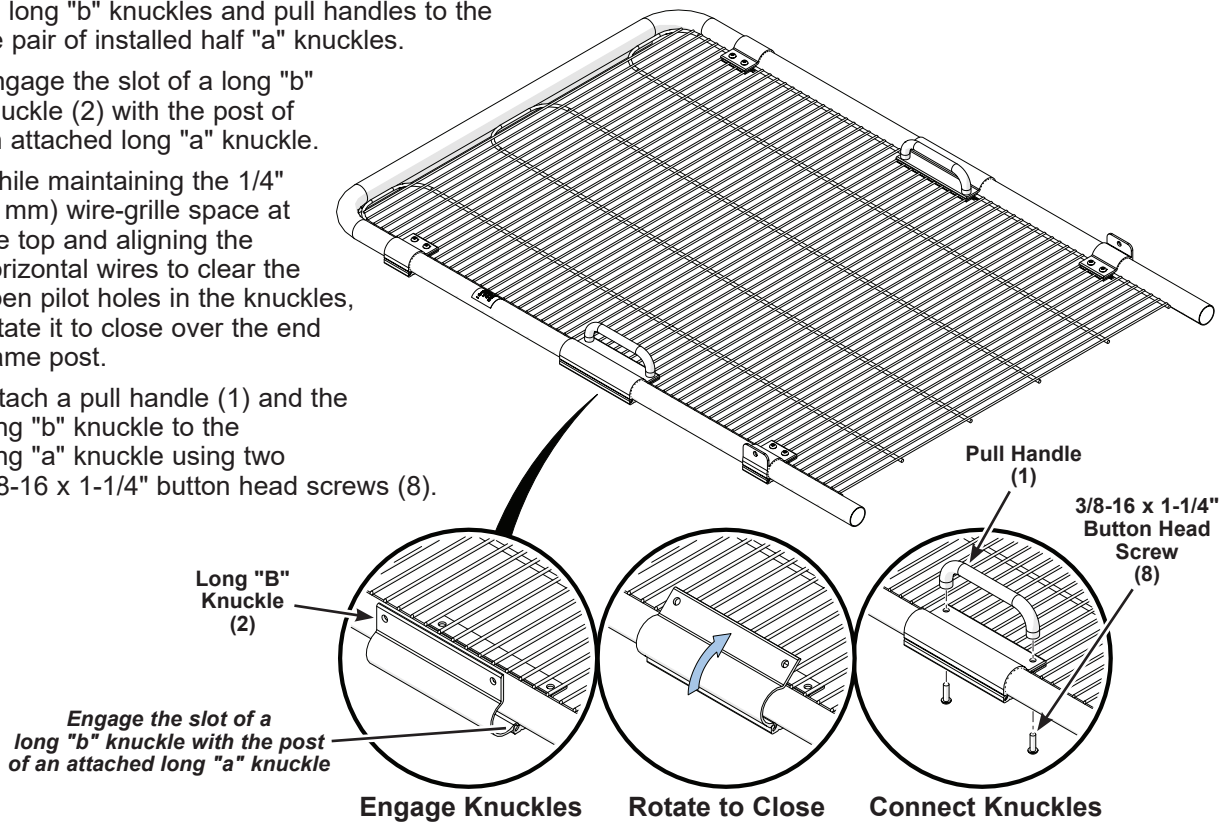

9. Insert the front end frame assembly (12) into the end frame posts at the front of the chassis. For orientation, the track followers are located at the front of the cart.

CAUTION

A dangerous pinch point develops when inserting an end frame into the chassis. Keep fingers clear of the insertion point.

- For orientation, the two screw heads near the bottom of the end frame posts must face toward the inside of the cart. Insert the end frame until both screw heads rest on the frame bumpers.
- Attach each frame bumper to the end frame and end frame post using a 1/4-14 x 1" self-drilling screw (7).

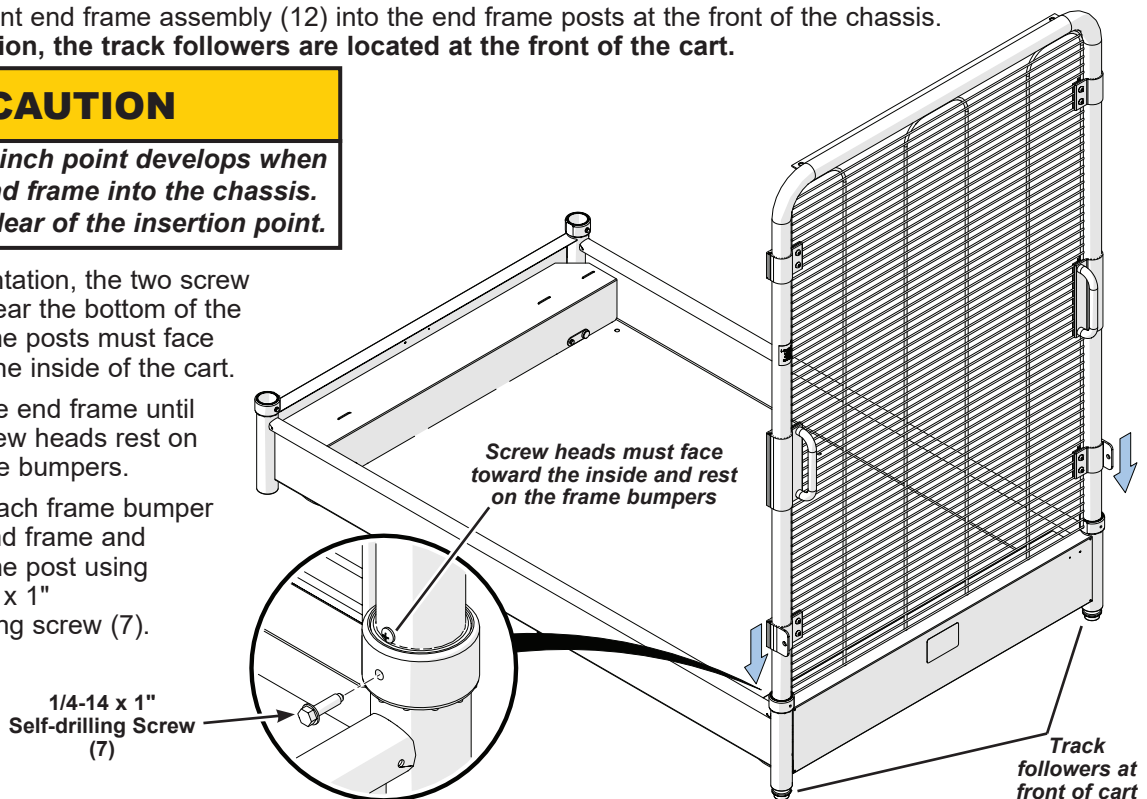

Cart Assembly (continued)

Assemble Rear End Frame

1. Lay the rear end frame assembly (13) flat **with the top ledge facing up**.
2. Attach a half "a" knuckle (41) toward the top and bottom of each rear end frame post using a 1/4-14 x 3/4" self-drilling screw (24) in each as shown.

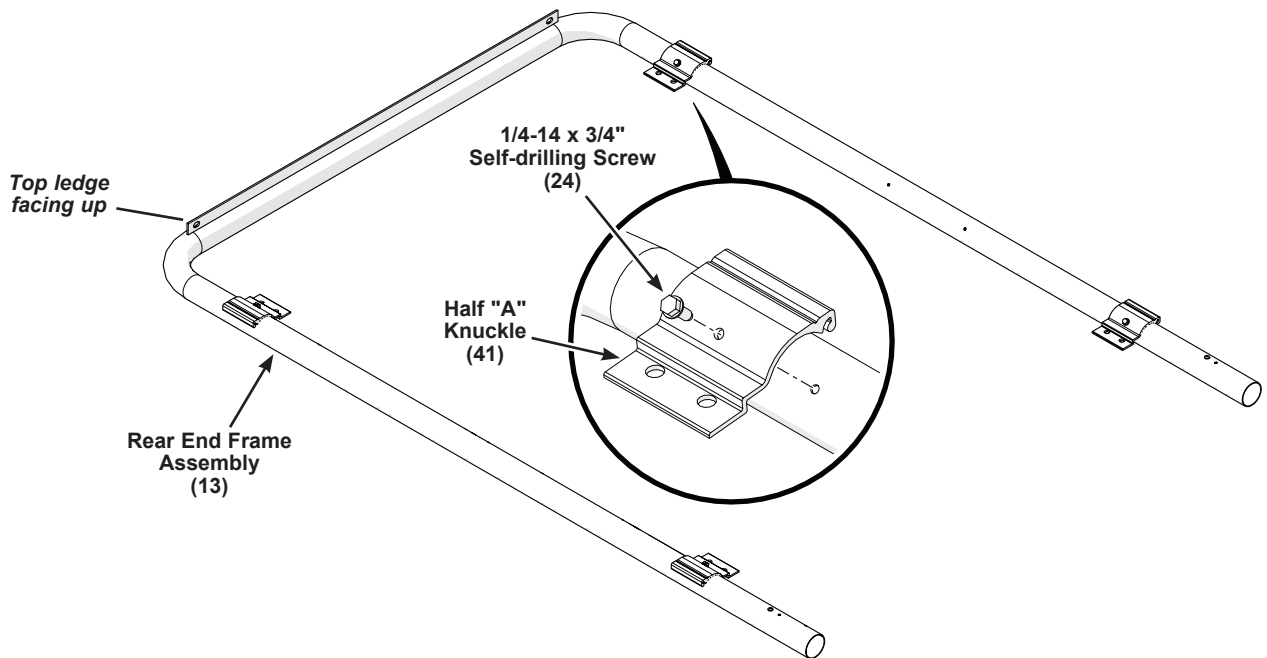

Cart Assembly (continued)

Assemble Rear End Frame (continued)

- Turn the rear end frame assembly over.
- With the horizontal wires facing up**, position the wire-grille end panel (17) to fit onto the attached "a" knuckles (41) and approximately 1/4" (6 mm) below the end frame horizontal tube.

NOTICE

The top wire of the wire-grille should be approx. 1/4" (6 mm) below the horizontal tube and facing up.

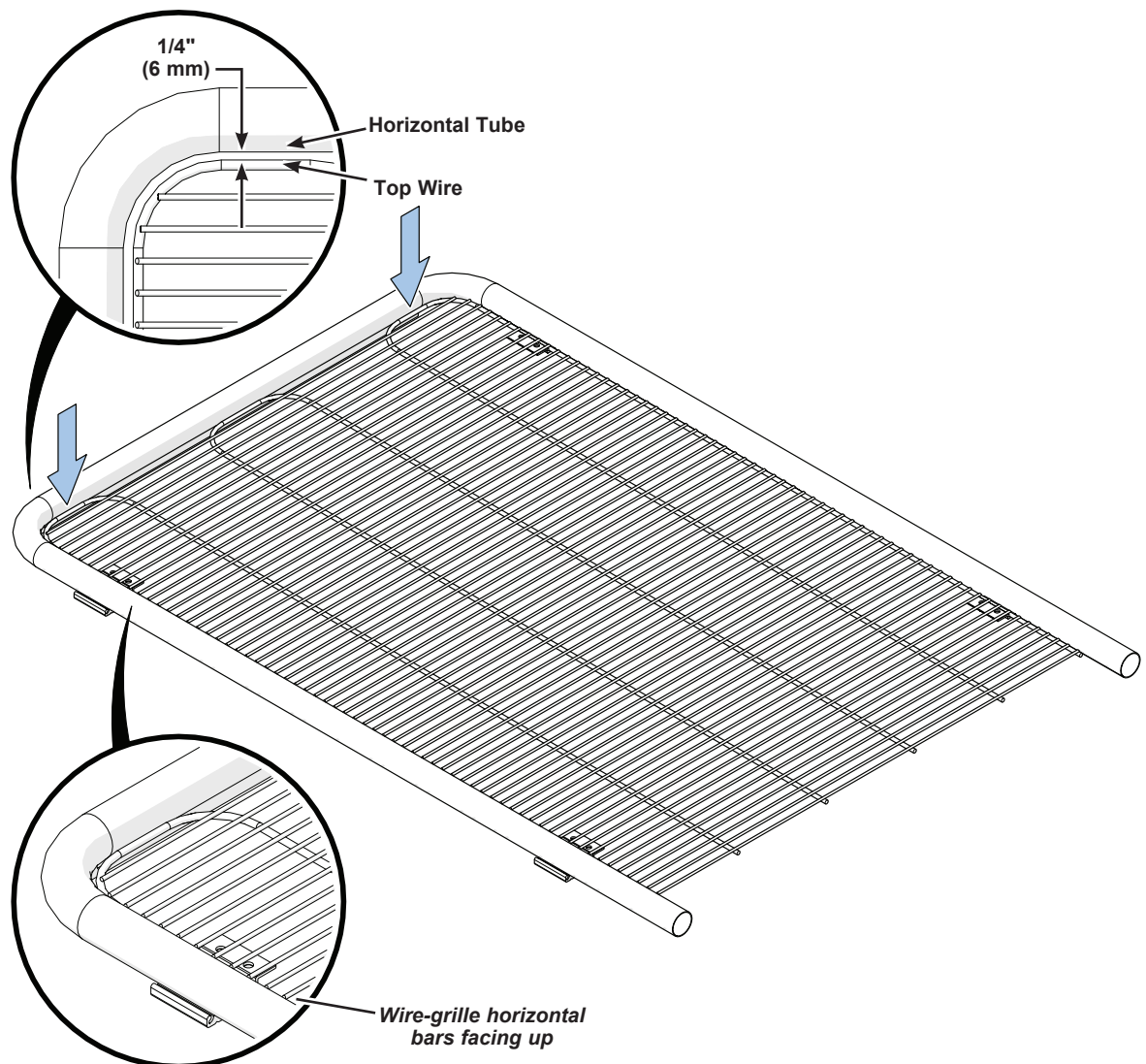

Cart Assembly (continued)

Assemble Rear End Frame (continued)

5. Attach half "b" knuckles to the installed half "a" knuckles.

- Engage the slot of a half "b" knuckle (42) with the post of an attached half "a" knuckle.
- While maintaining the 1/4" (6 mm) wire-grille space at the top and aligning the horizontal wires to clear the open pilot holes in the knuckles, rotate it to close over the end frame post.
- Attach the half "b" knuckle to the half "a" knuckle using two 3/8-16 x 7/8" button head screws (10) and 3/8-16 acorn nuts (6).

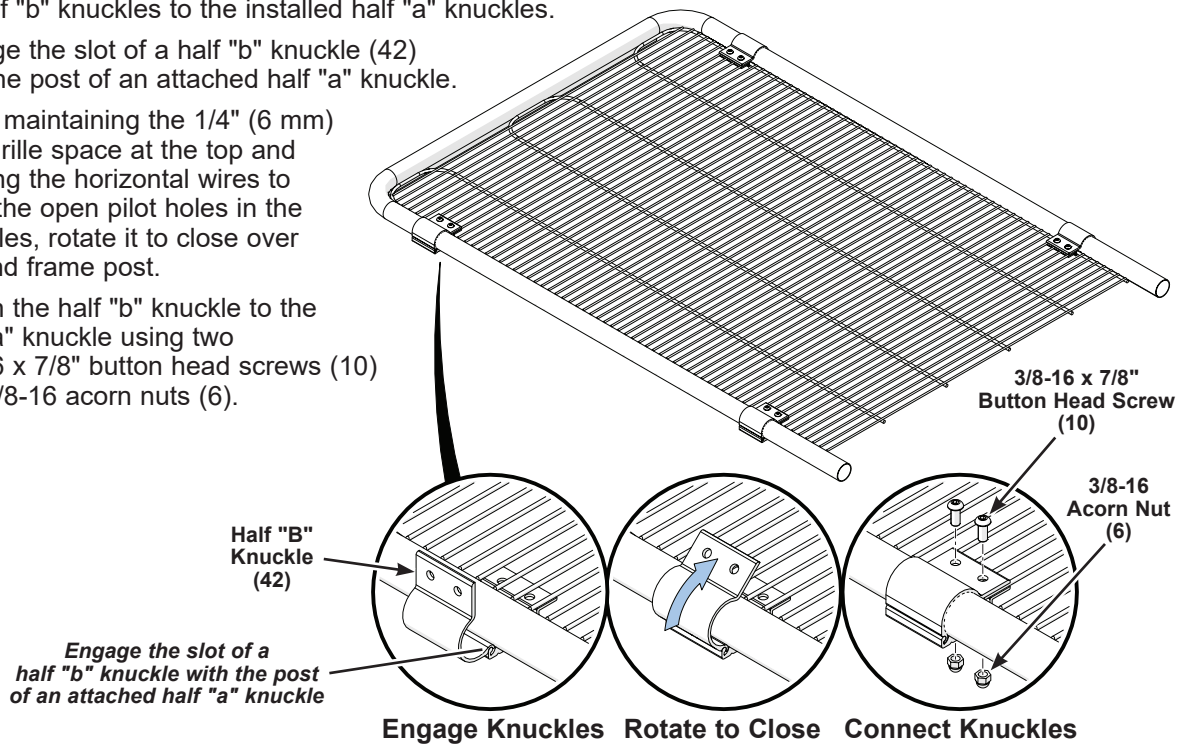

9. Insert the front end frame assembly (12) into the end frame posts at the front of the chassis.
For orientation, the track followers are located at the front of the cart.

CAUTION

A dangerous pinch point develops when inserting an end frame into the chassis. Keep fingers clear of the insertion point.

- For orientation, the two screw heads near the bottom of the end frame posts must face toward the inside of the cart. Insert the end frame until both screw heads rest on the frame bumpers.
- Attach each frame bumper to the end frame and end frame post using a 1/4-14 x 1" self-drilling screw (7).

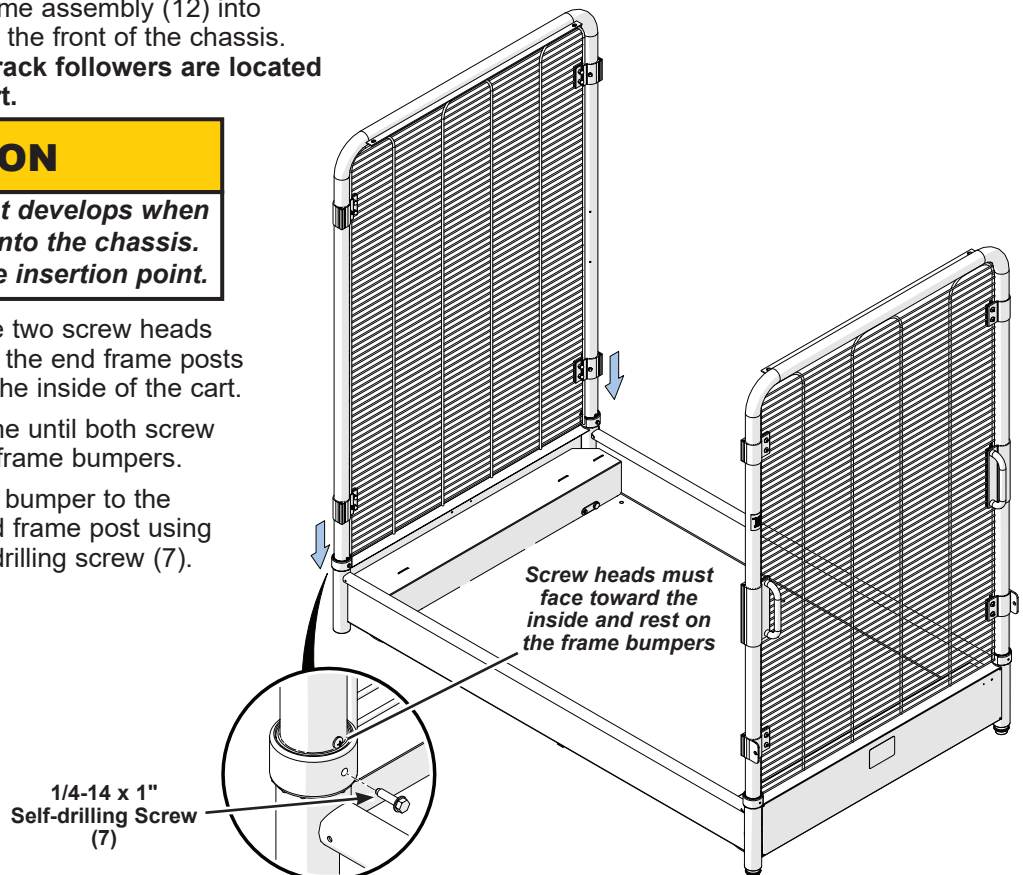

Cart Assembly (continued)

Top Panel Assembly

1. Lay the top panel flat with the black side facing upward.

NOTICE

To prevent scratching the top panel, use a table or cardboard packaging as a work surface.

2. Attach the top panel extrusions (15) to both sides of the top panel (16) using two 3/8-16 x 1-1/4" button head screws (8), 3/8" x 1-1/4" flat washers (5) and 3/8-16 acorn nuts (6) in the middle set of pilot holes.

Only hand-tighten the fasteners.

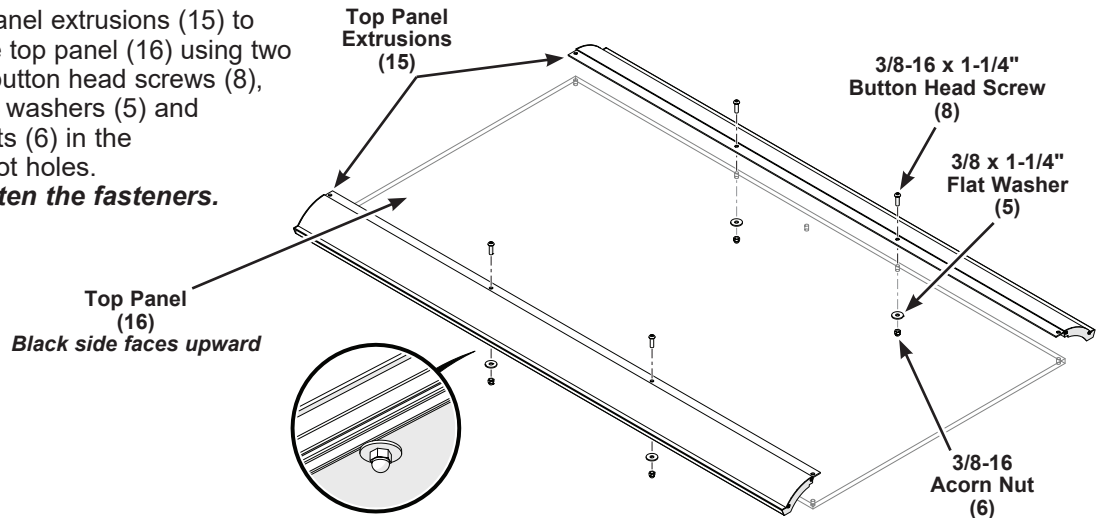

3. Using two people, lift the top panel assembly onto the ledges at the top of the front and rear end frames.

Align the open pilot holes at both ends of the top panel assembly with the pilot holes on the ledges of the end frames.

CAUTION

Never stand on a cart, use a ladder or step stool if necessary.

4. Attach the top panel assembly to both end frames using two 3/8-16 x 1-1/4" button head screws (8) and 3/8-16 acorn nuts (6) on each side.
5. Tighten the four button head screws and four acorn nuts attached in step 2.
6. Make sure that all fasteners on the cart are tight and the cart assembly is complete.

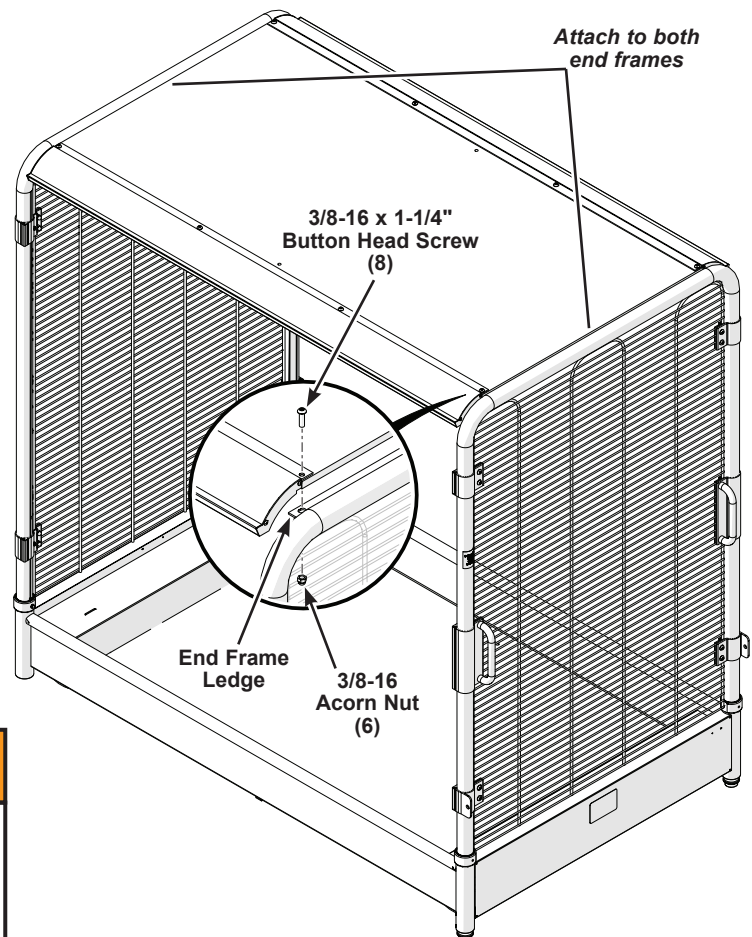

WARNING

Do not place more than 150 lb (68 kg) onto the cart top panel. Failure to observe this warning can result in a structural failure and inability to open and close bypass doors.

Moving Carts

General

⚠ WARNING

Two people must work together when moving a cart not on a track, one person pushing at the rear and one person guiding the cart at the front.

⚠ WARNING

Always move carts at a slow walk or about 1' (305 mm) per second. Moving the cart rapidly and striking an obstruction can result in tipping over.

⚠ WARNING

Never place hands or feet onto the track or cart pathway when moving carts.

⚠ WARNING

When moving the cart, never allow people to ride on the cart.

⚠ WARNING

Never place a cart sideways on an inclined ramp where they can tip over.

X-Carts have stationary casters and are designed to be moved along a floor track.

Team Carts can be moved along a floor track but have swiveling casters that allow for steering so they can also be used off of a track. When off the track, only move Team Carts with the track followers retracted.

To retract or engage the track followers on a Team Cart:

1. Retract the track followers by pulling each one upward until it engages with the locking lever.
2. Release the track follower by pulling the locking lever away from the follower.

See the following page for moving carts on and off a floor track.

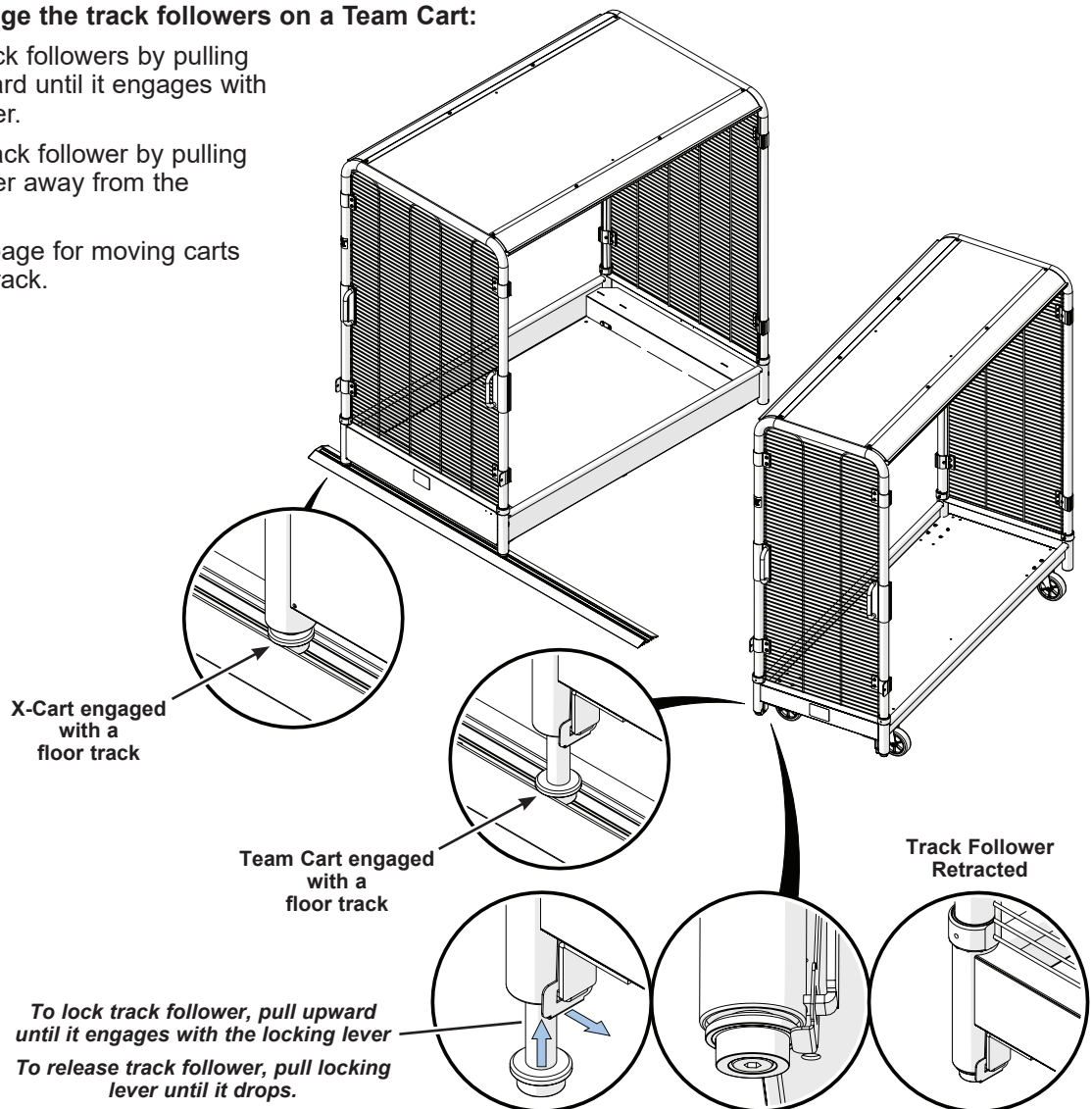

Cart Assembly (continued)

Moving Carts On an Off of a Floor Track

Either roll the cart onto an open end of floor track or lift it onto the track.

1. Move the cart to the track. Two or more people must work together when moving a cart or if a cart must be lifted over a floor track
2. Place the track followers into the track follower channel and the cart should glide along the track.
3. To remove a Team Cart from the track, retract both track followers by pulling each one upward until it locks in place. Release the track follower by pulling the locking lever away from the follower.

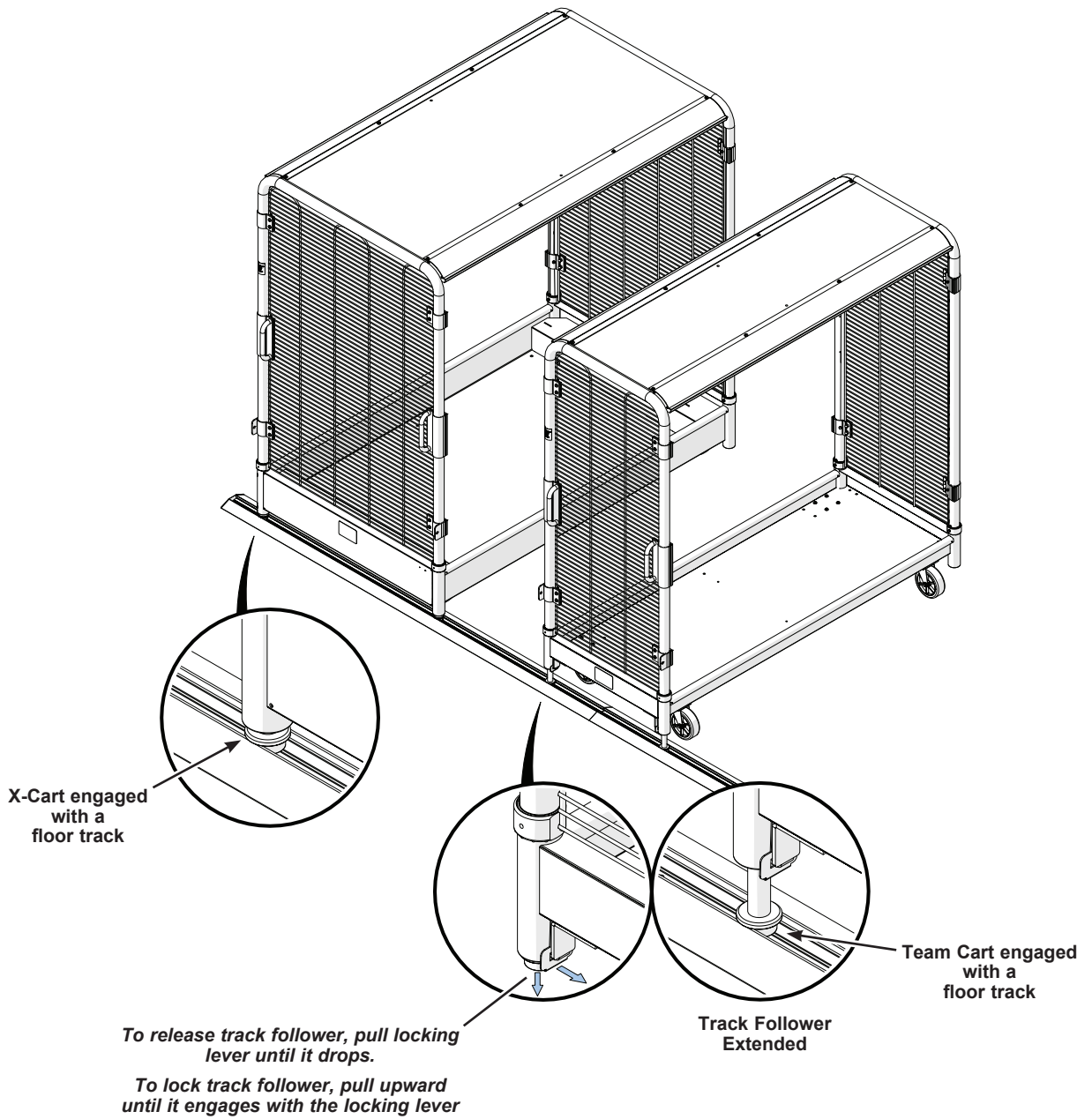

Replacement Parts

X-Cart Chassis

NOTICE

Applies to both 32" (813 mm) and 48" (1219 mm) widths, specify width when ordering.

Item	Description
3	Frame Bumper
7	1/4-14 x 1" Self-drilling Screw
14	X Cart Chassis
30	Track Follower Shoulder Bolt
31	Roller
32	Plunger
33	3/4" Poly Wheel
34	Axle Pin
35	1/4-14 x 3/4" Self-drilling Screw
36	GearBoss Decal

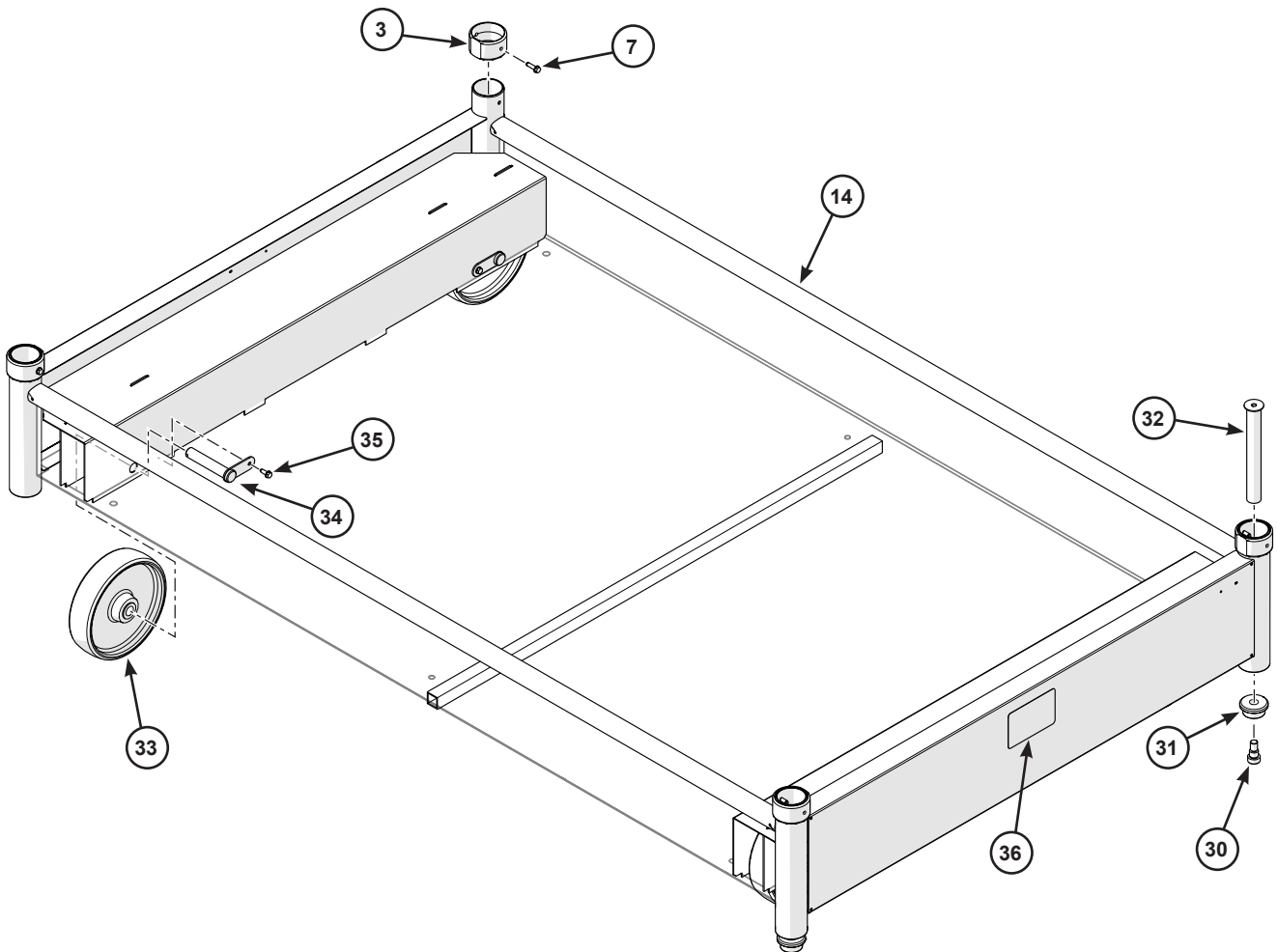

48" X-Cart shown

Replacement Parts (continued)

Team Cart Chassis

NOTICE

Applies to both 32" (813 mm) and 48" (1219 mm) widths, specify width when ordering.

Item	Description
3	Frame Bumper
6	3/8-16 Acorn Nut
7	1/4-14 x 1" Self-drilling Screw
14	Team Cart Chassis
30	Shoulder Bolt
31	Track Follower
32	Plunger Shaft
36	GearBoss Decal
37	3/8-16 Lock Nut
38	6" Dia Swivel Caster
39	3/8-16 x 3/4" Button Head Screw
40	Plunger Clip Backer
41	Plunger Clip

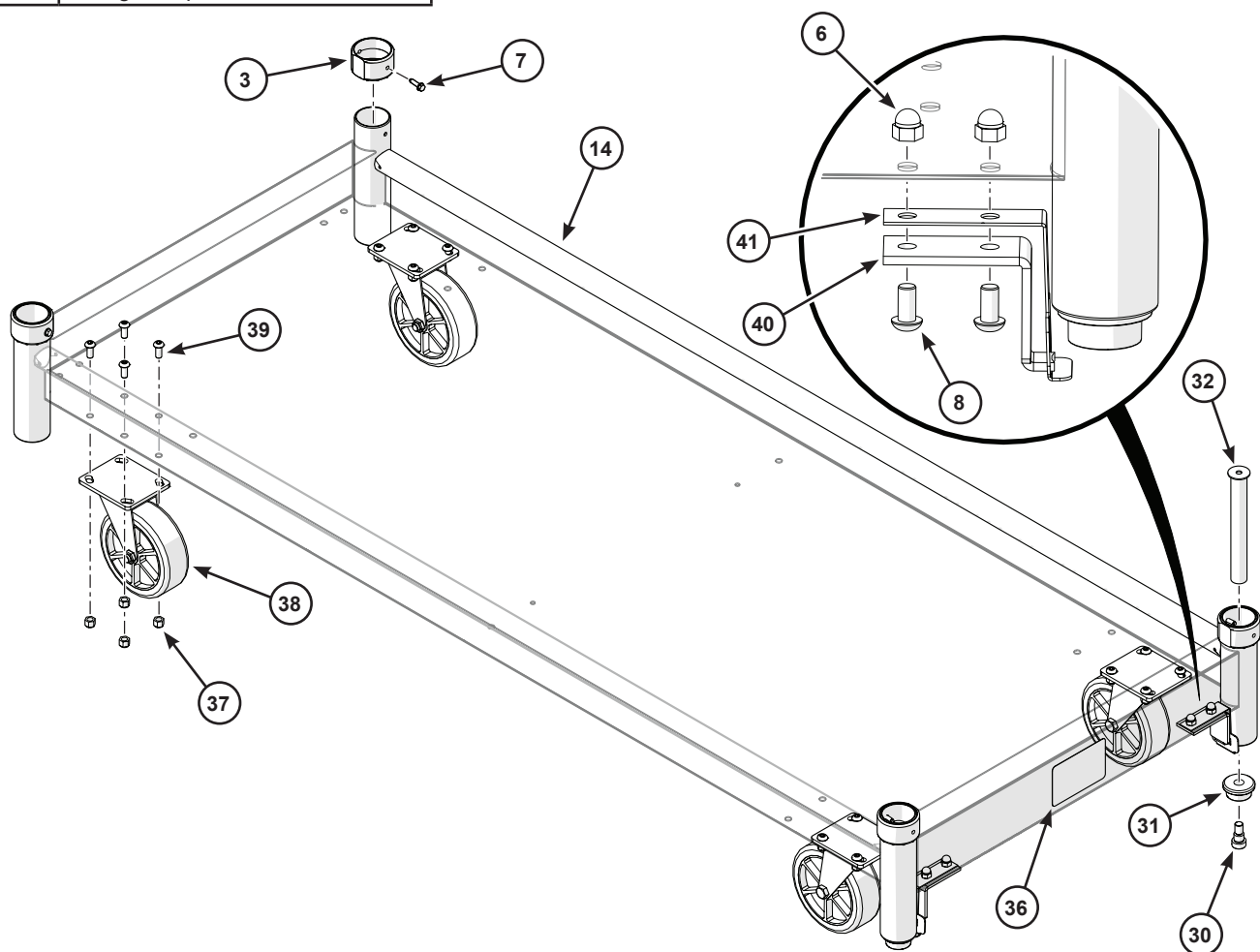

32" Team Cart shown

Replacement Parts (continued)

End Frame

NOTICE

Applies to both 32" (813 mm) and 48" (1219 mm) widths, specify width when ordering.

Item	Description
1	Pull Handle
2	Long "B" Knuckle
4	Half Lock "B" Knuckle
6	3/8-16 Acorn Nut
7	1/4-14 x 1" Self-drilling Screw
8	3/8-16 x 1-1/4" Button Head Screw
10	3/8-16 x 7/8" Button Head Screw
25	10-16 x 3/4" Sheet Metal Screw
40	End Frame
41	Half "A" Knuckle
42	Half "B" Knuckle
43	Long "A" Knuckle

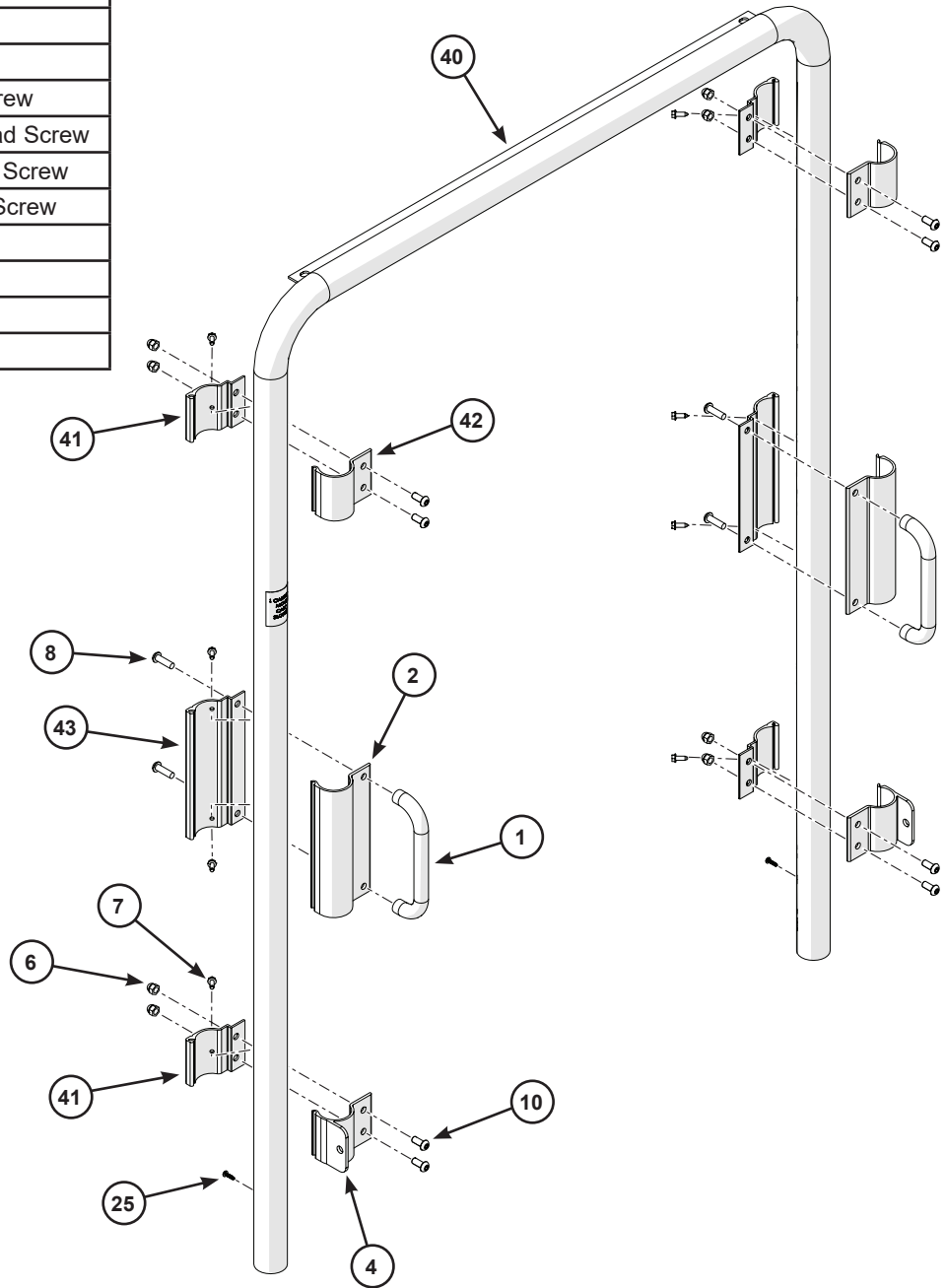

Replacement Parts (continued)

Wire-grille End Panel

NOTICE

Applies to both X-Carts (shown) and Team Carts in 32" (813 mm) and 48" (1219 mm) widths, specify both when ordering.

Item	Description
17	Wire-grille End Panel

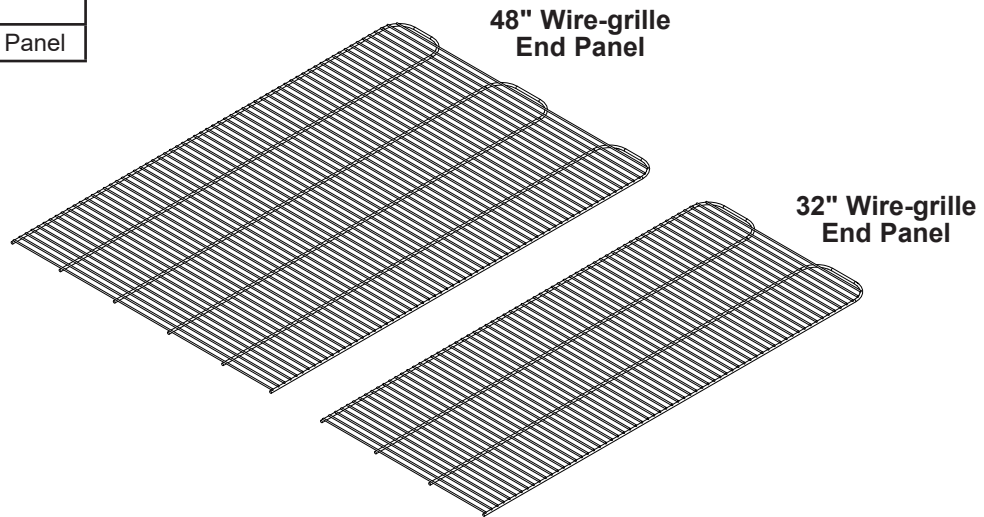

Top Panel Assembly

NOTICE

Applies to both X-Carts (shown) and Team Carts in 32" (813 mm) and 48" (1219 mm) widths, specify both when ordering.

Item	Description
5	3/8x1-1/4 Flat Washer
6	3/8-16 Acorn Nut
8	3/8-16 x 1-1/4" Button Head Screw
15	Top Panel Extrusion Assembly
16	Top Panel

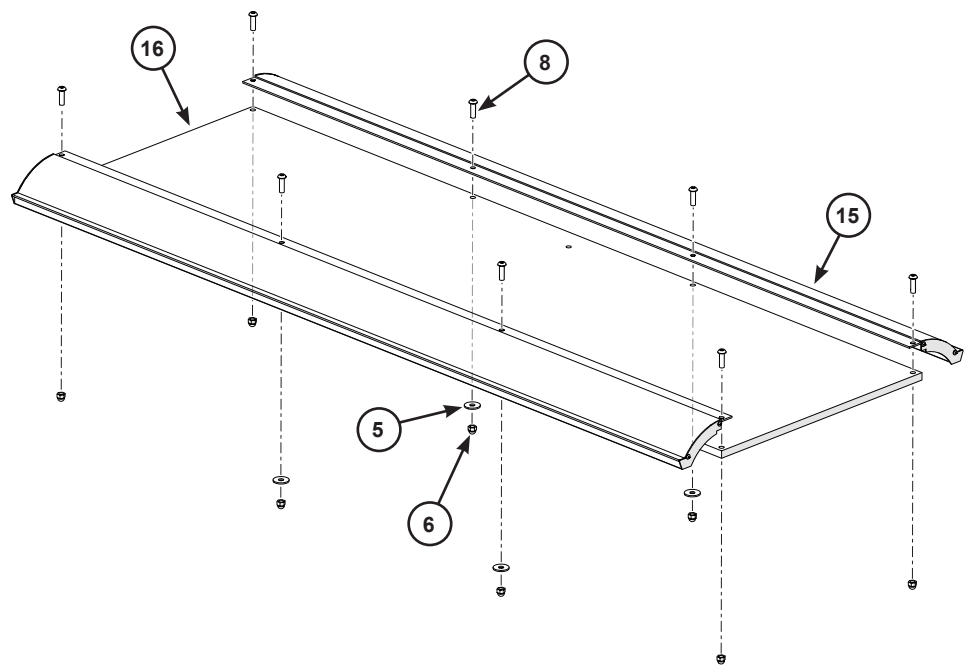

Replacement Parts (continued)

Floor Track

Item	Description
18	Standard Floor Track
19	1/8 x 2" Spring Pin
20	8-18 x 3/4" Self-drilling Screw
21	Floor Track End Cap

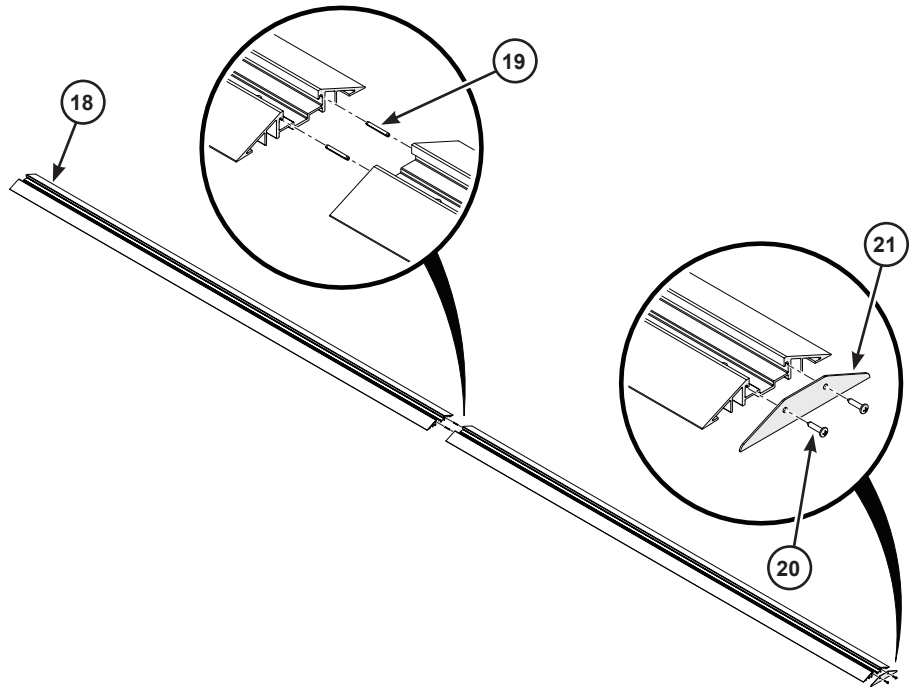

Track Stop Bracket

Item	Description
22	Track Stop Bracket
23	Track Stop Bumper
24	1/4-14 x 3/4" Self-drilling Screw

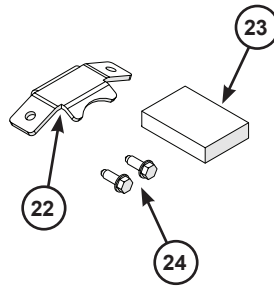

Adjustable Track Lock

Item	Qty	Description
26	1	Track Lock Pivot Weldment
27	1	Track Lock Bracket
28	1	Track Lock Toggle
29	1	Track Lock Handle

